

Coastline SWB Wardrobe

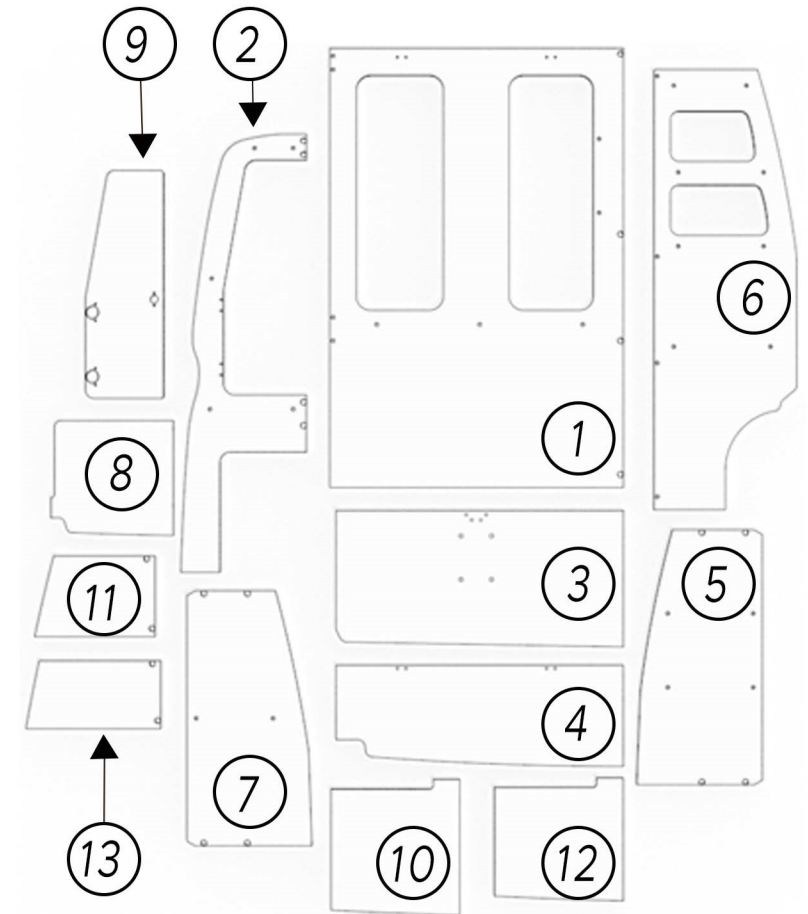

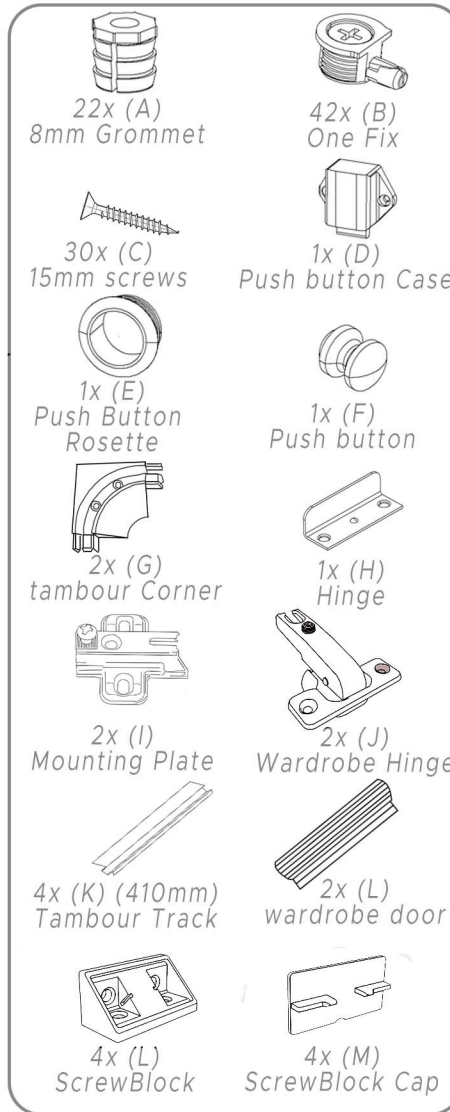
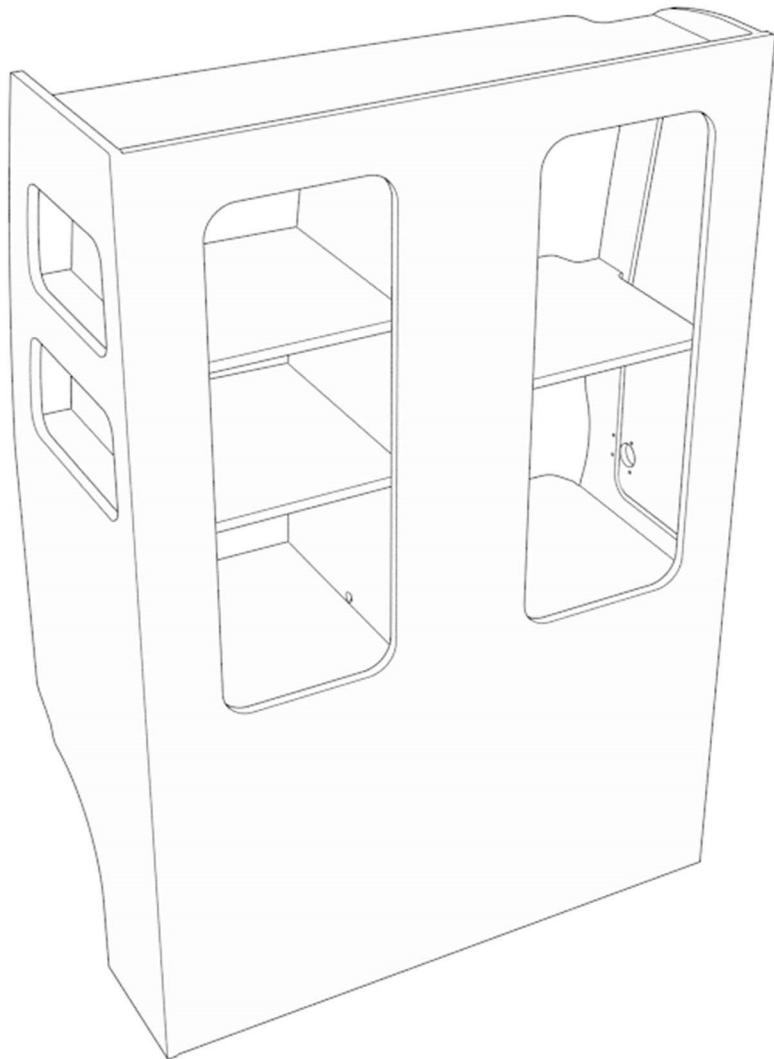
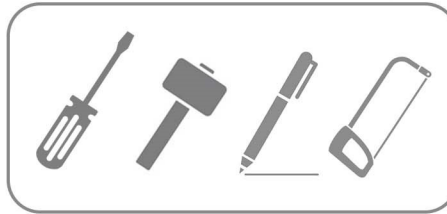
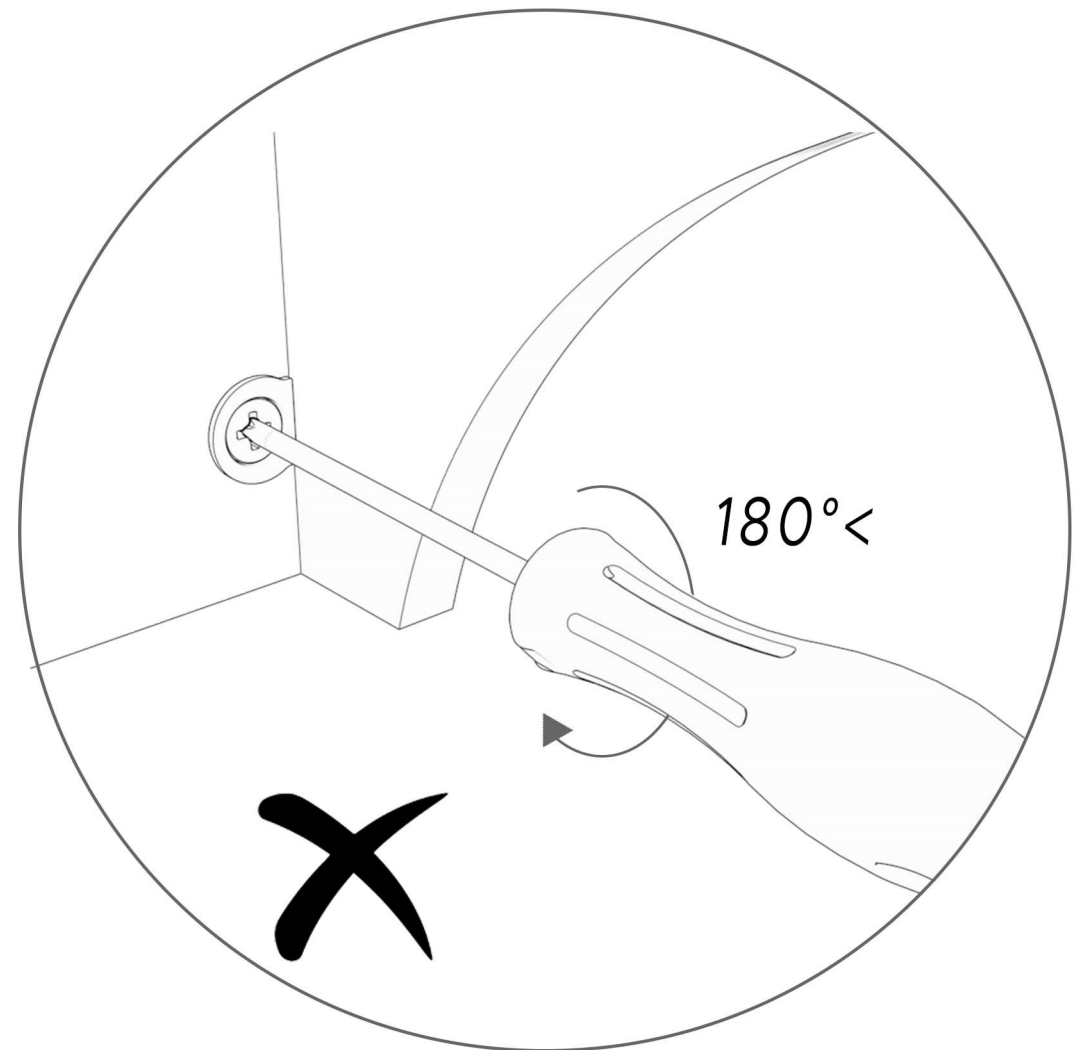
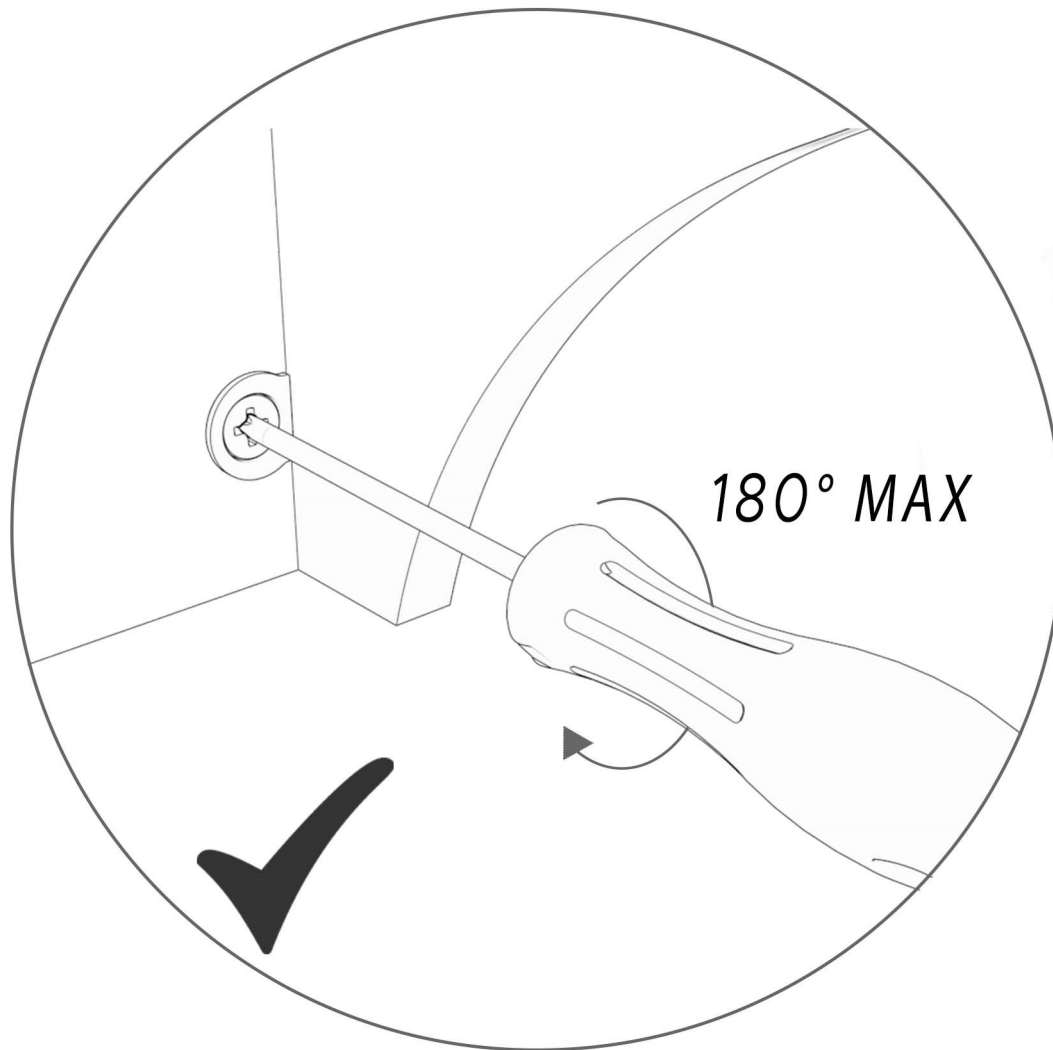

*Do not over tighten Onefix
Connectors!*

1.

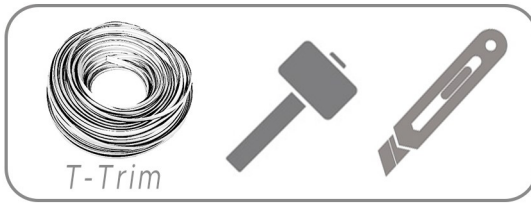

All pieces must have T-Trim applied before assembly!

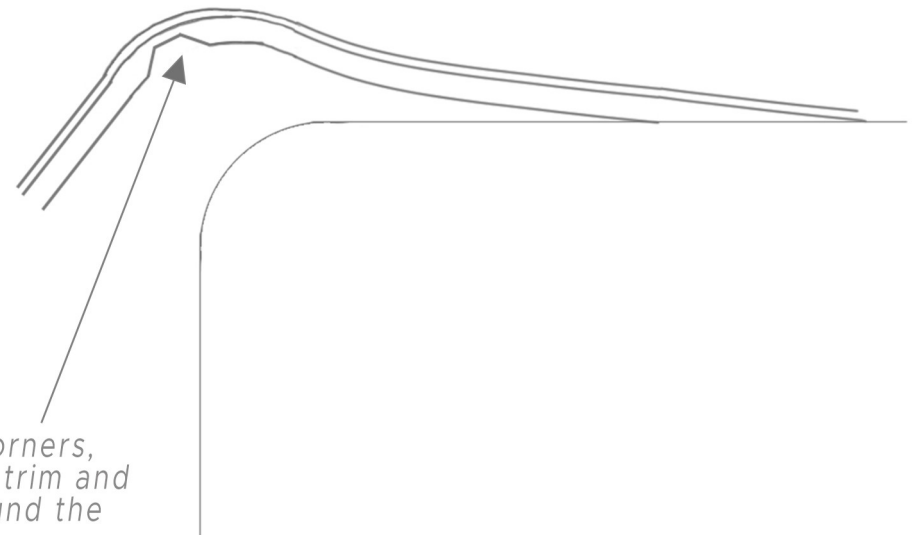
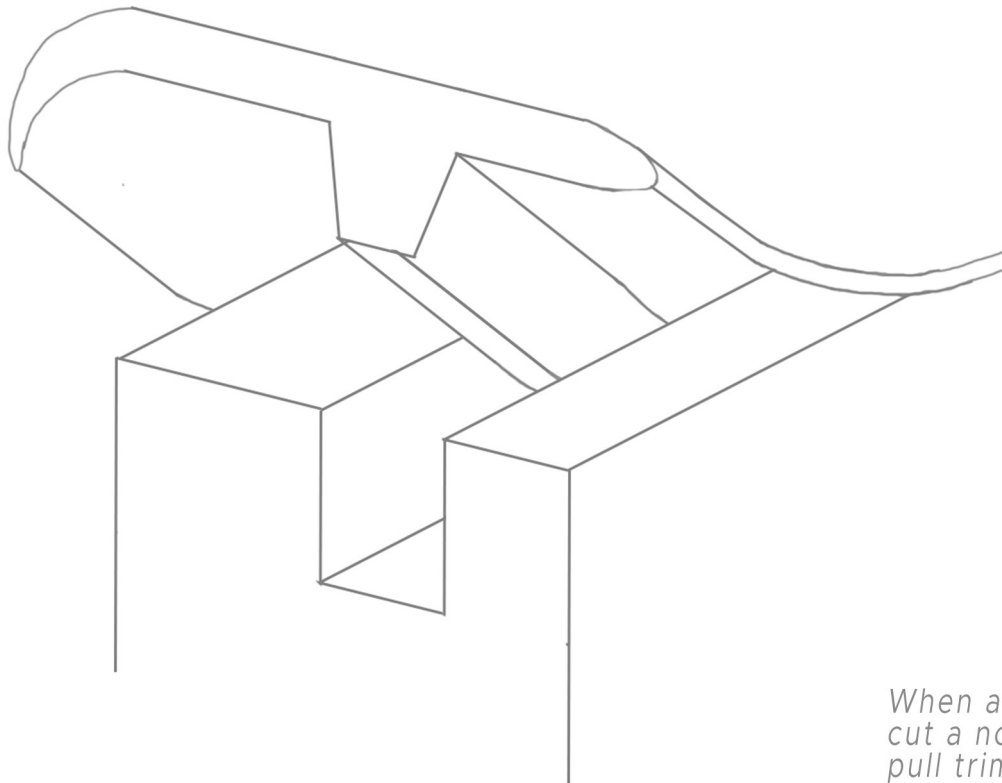
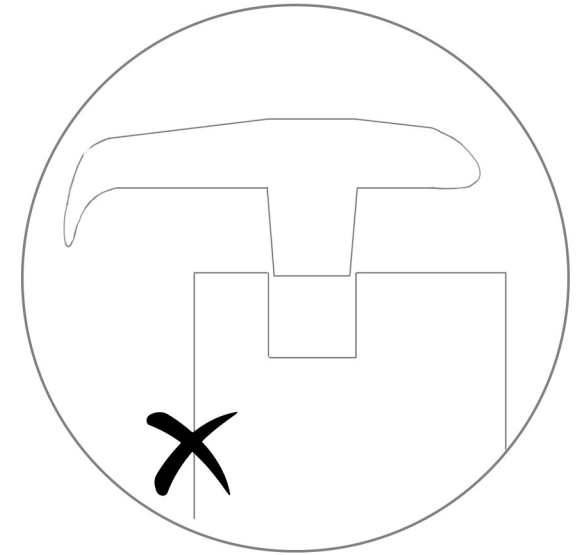
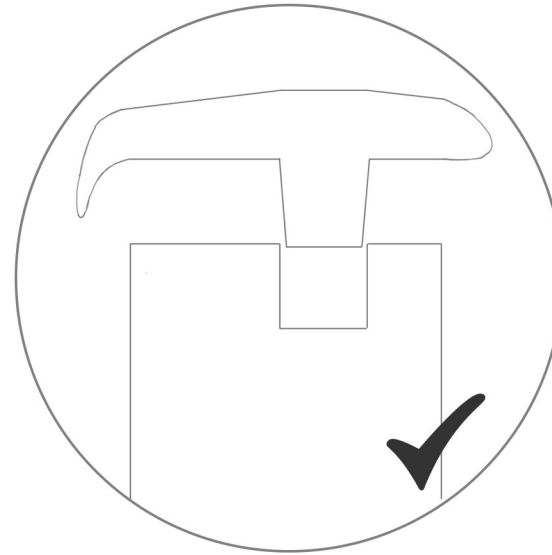

When applying to corners, cut a notch into the trim and pull trim tightly around the corner.

2.

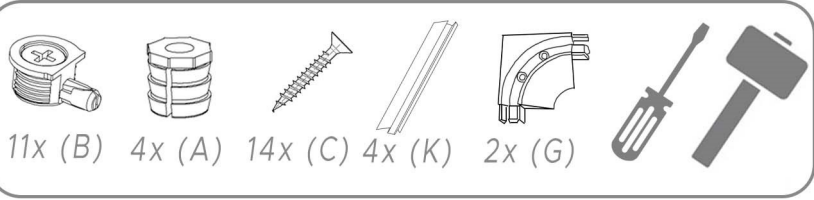

2.a

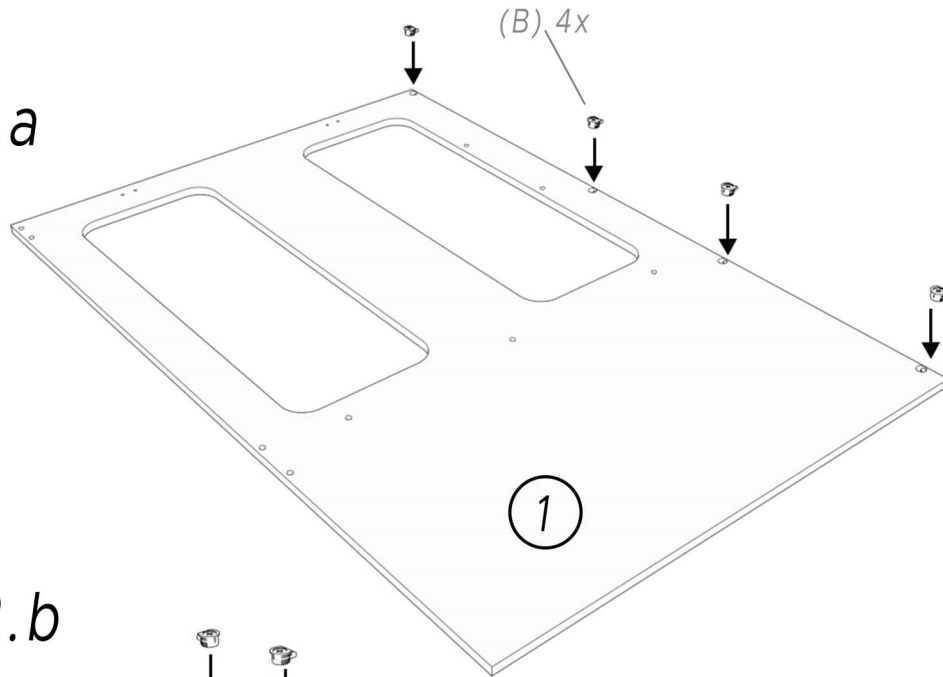

2.b

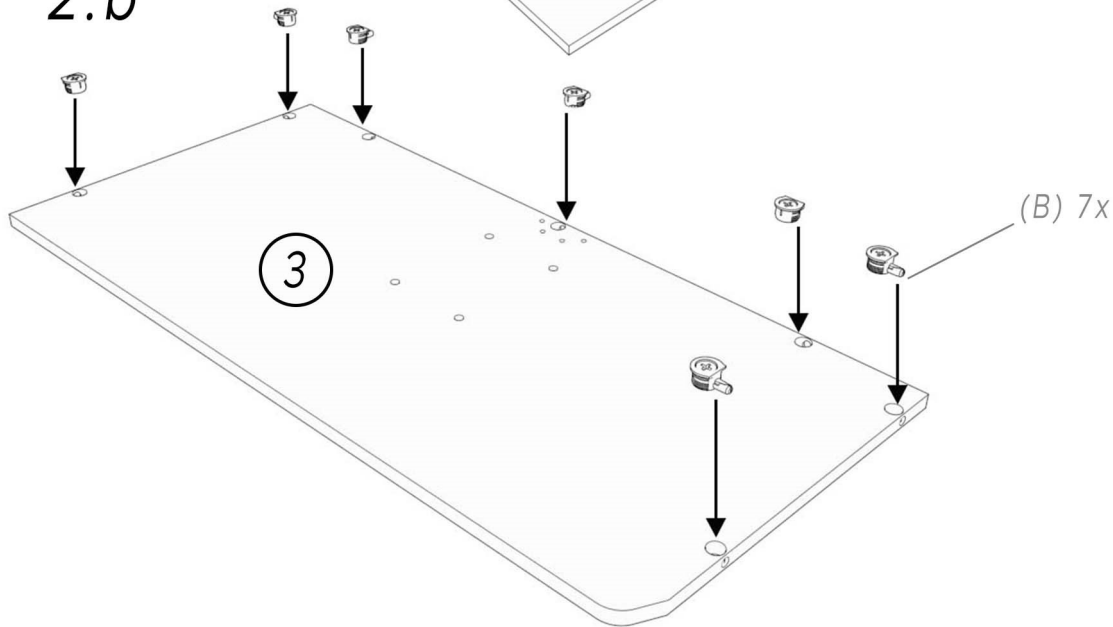

2.c

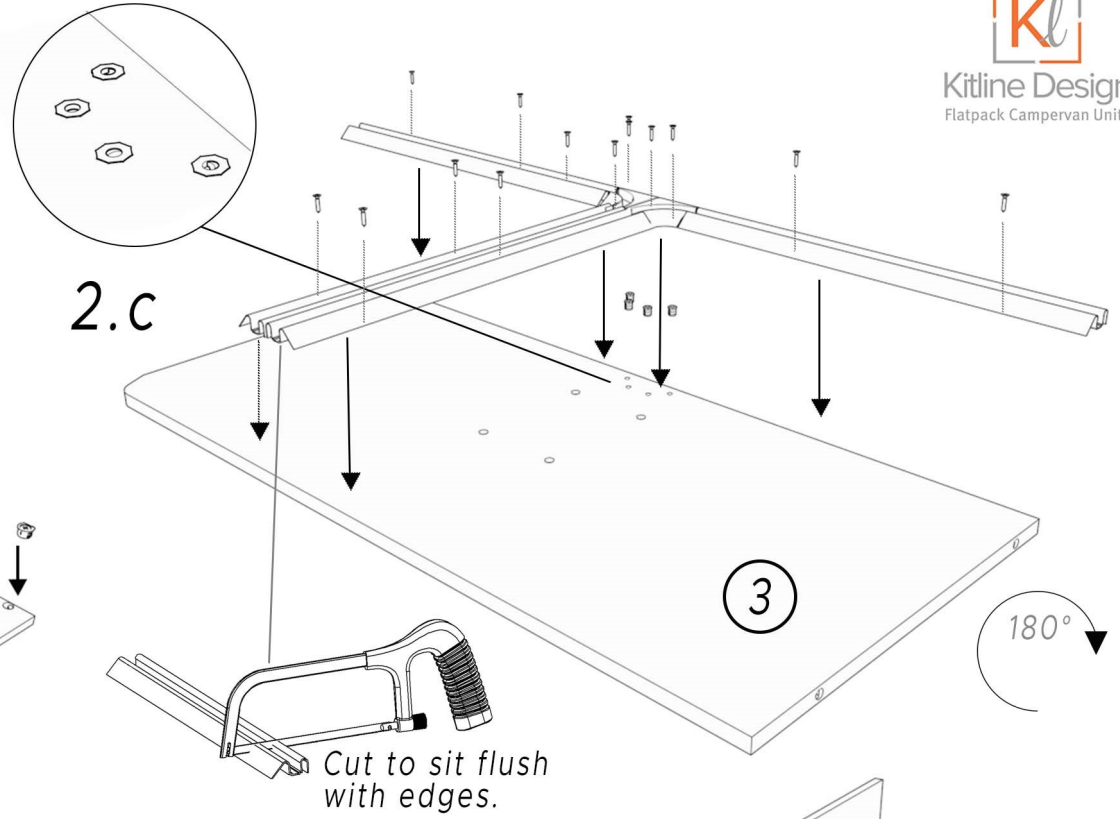

2.d

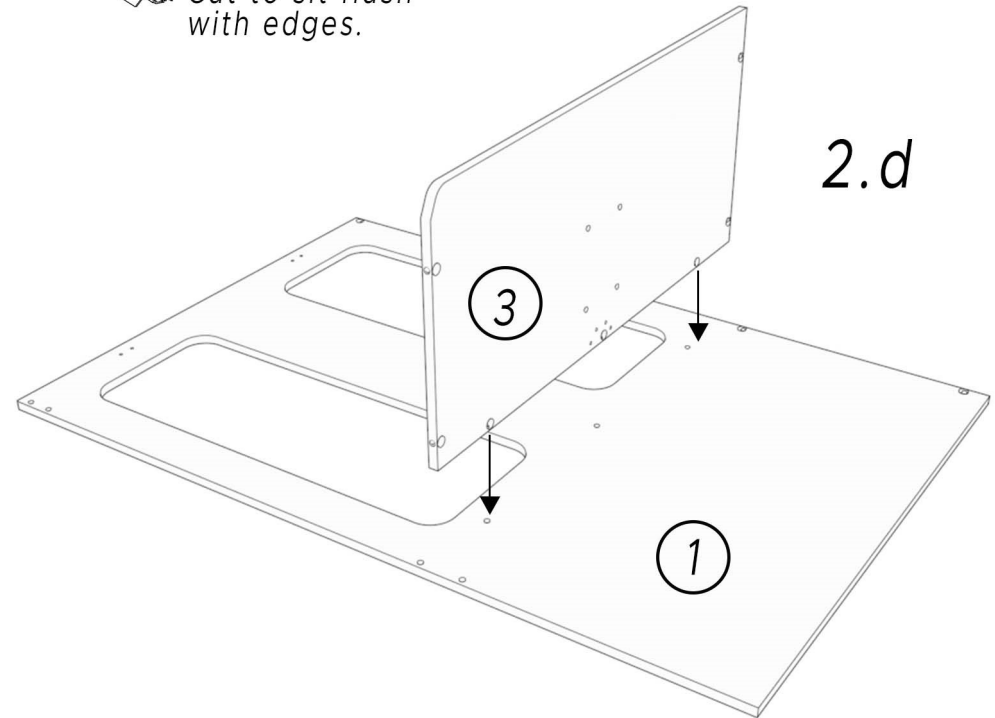

3.

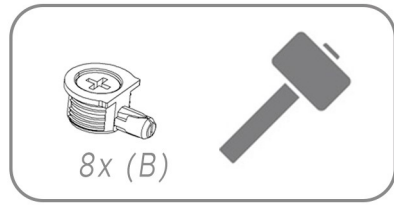

3.a

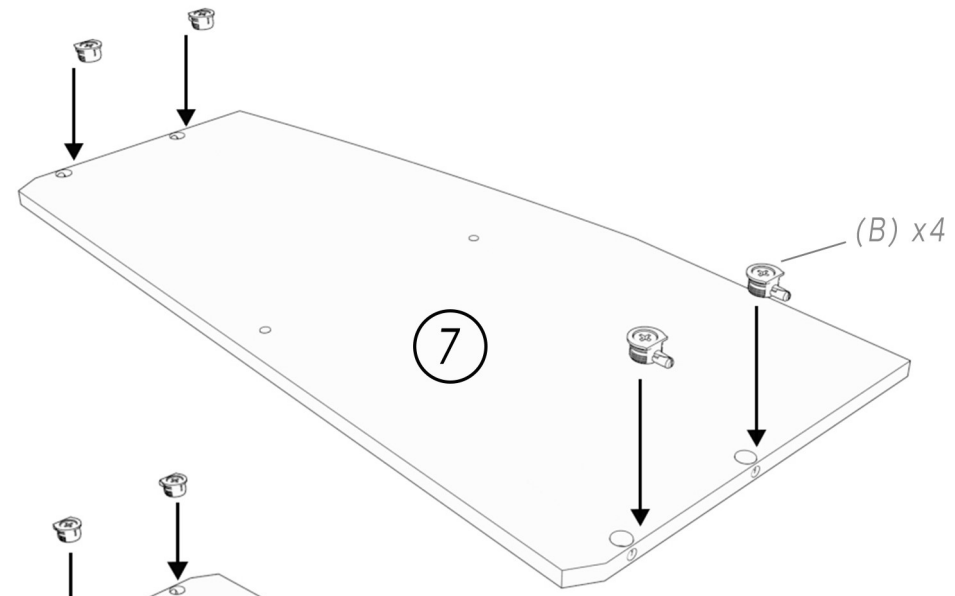

3.b

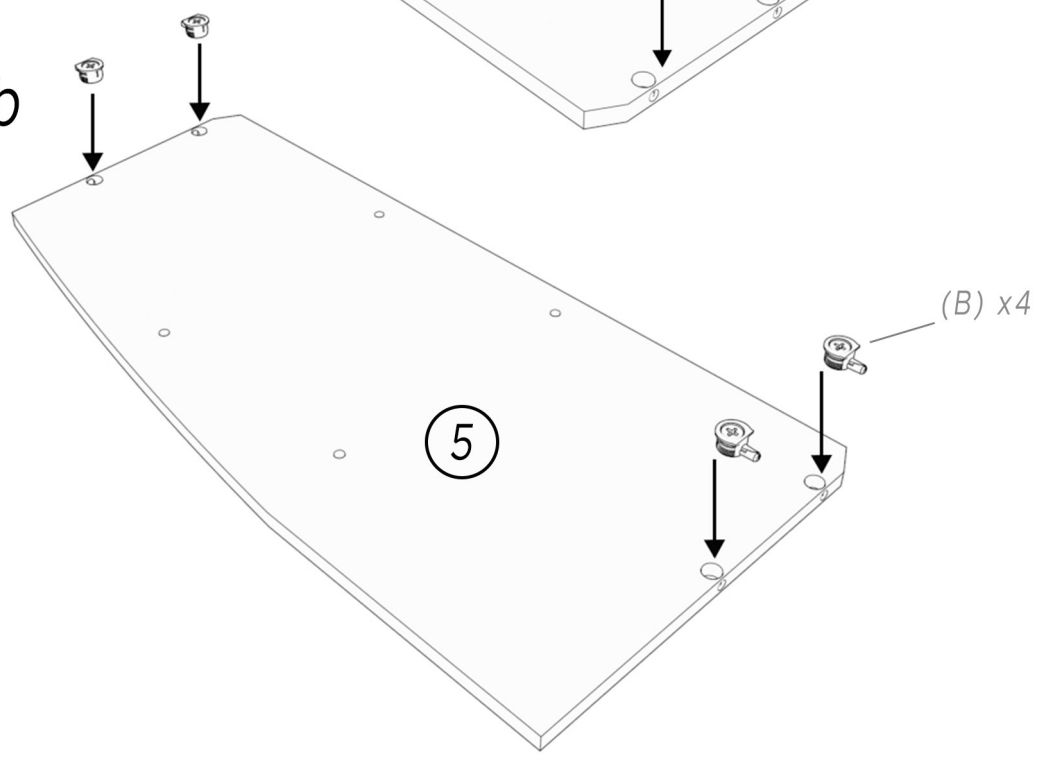

3.c

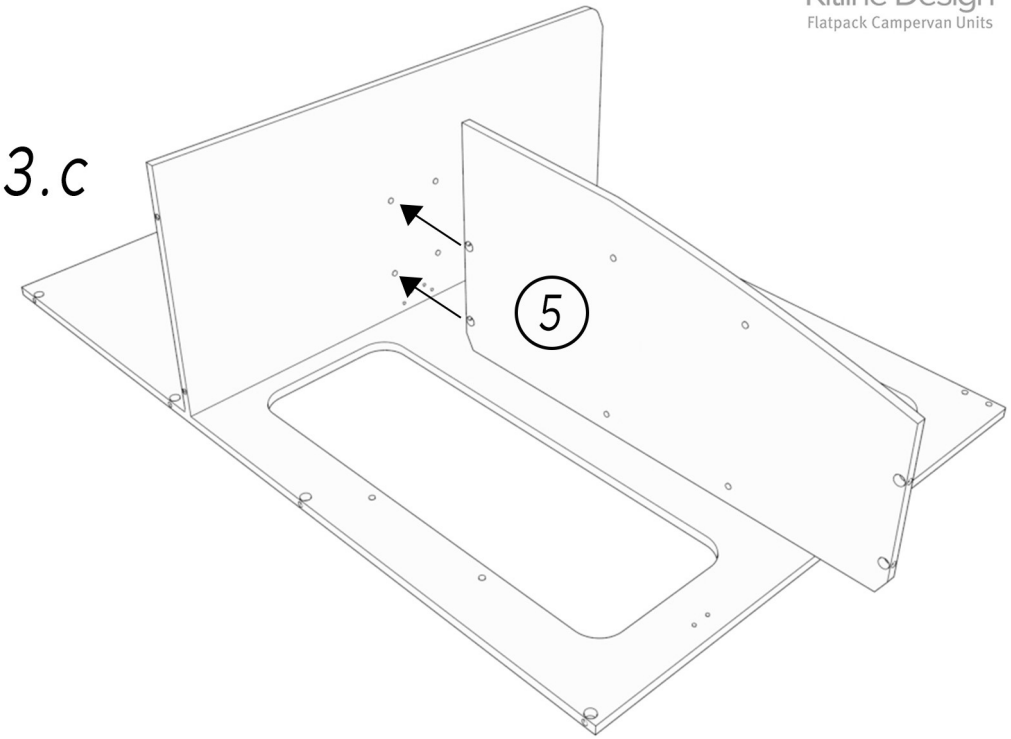

3.d

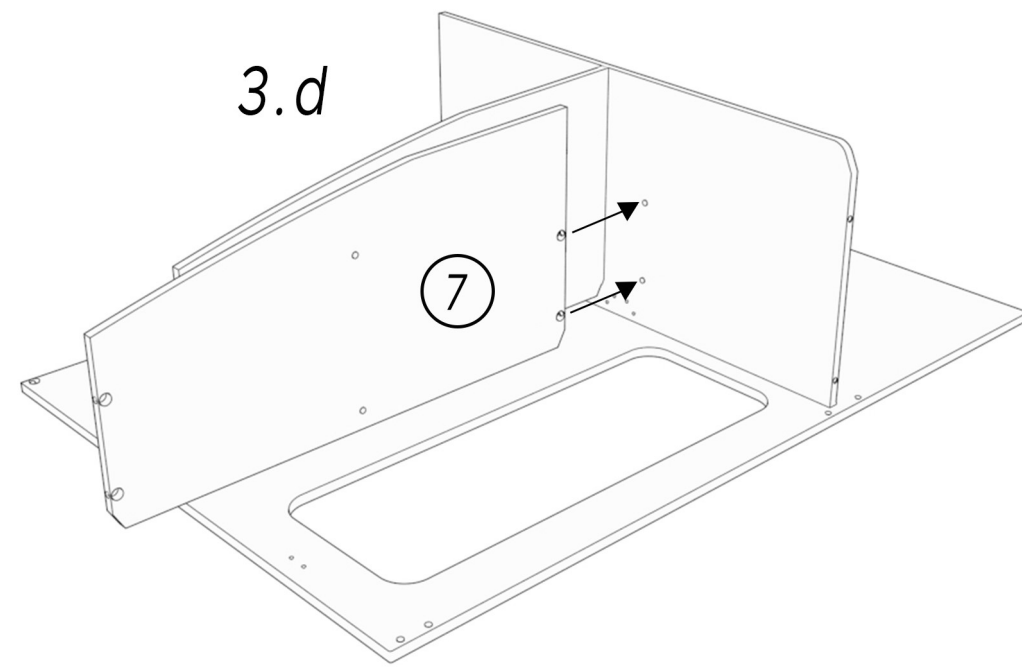

4.

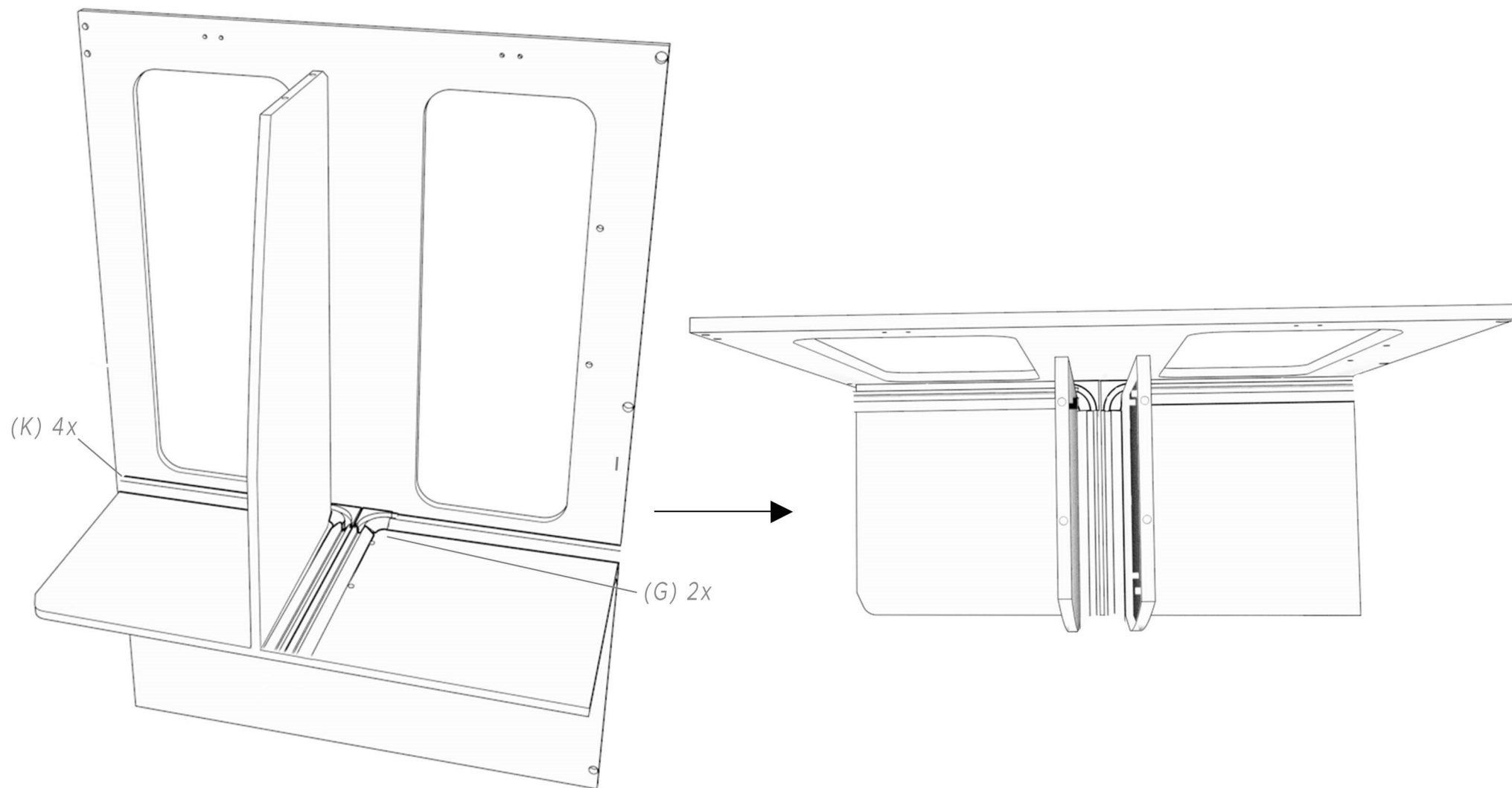

5.

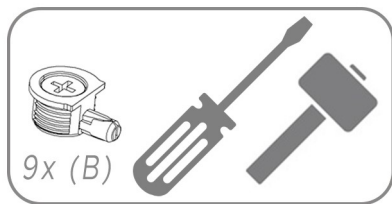

(B) 3x

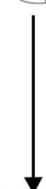

8

5.a



(B) 4x



12

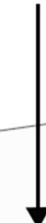

(B) 2x

13

5.b

8

5.c

12

13

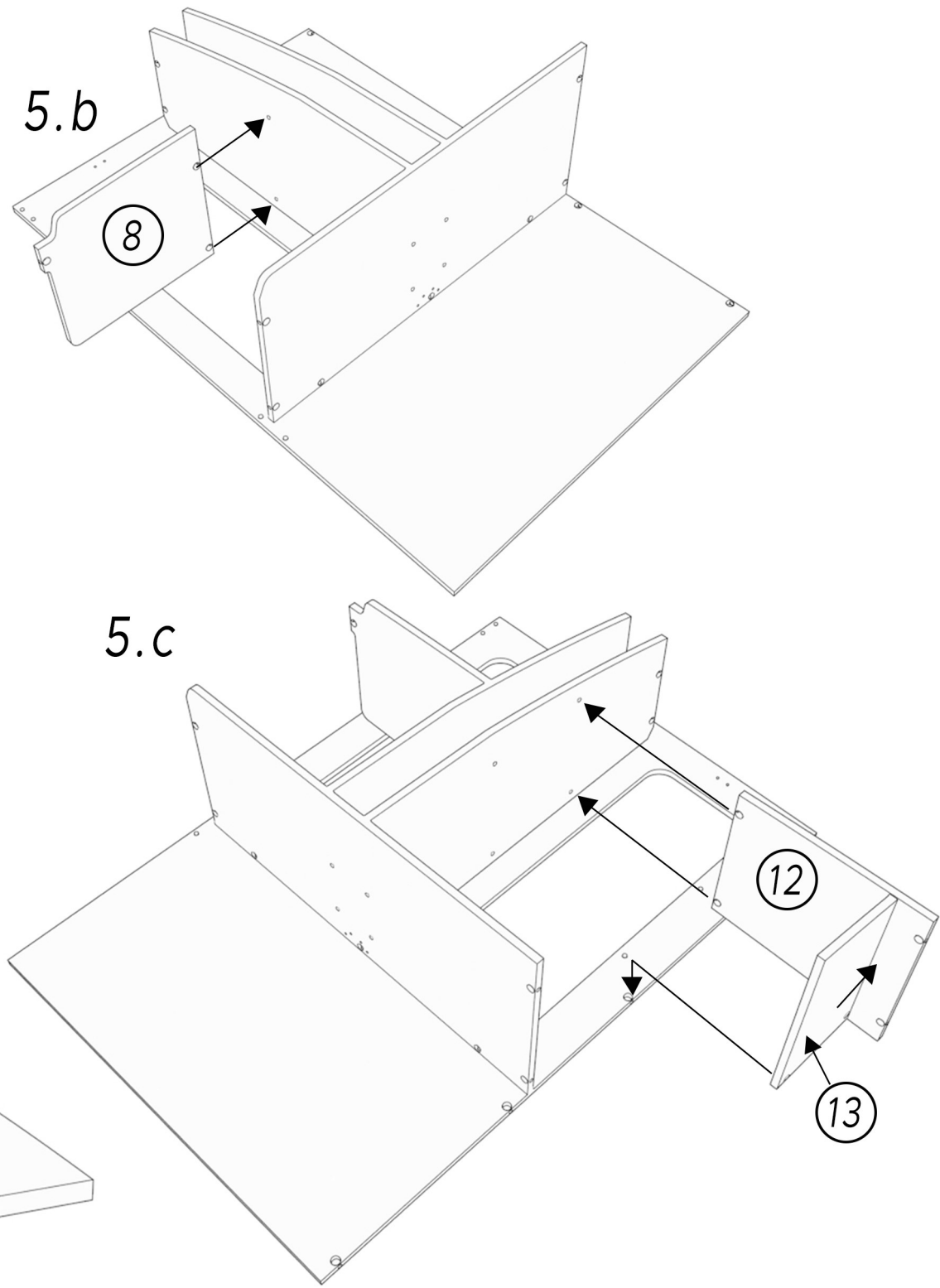

6.

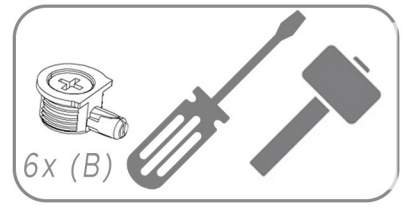

6.a

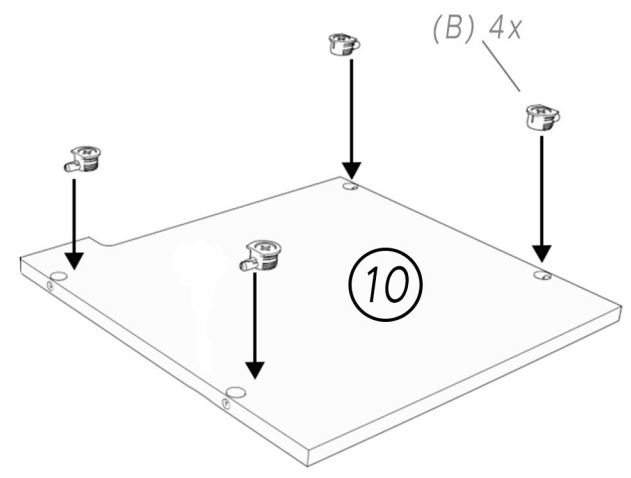
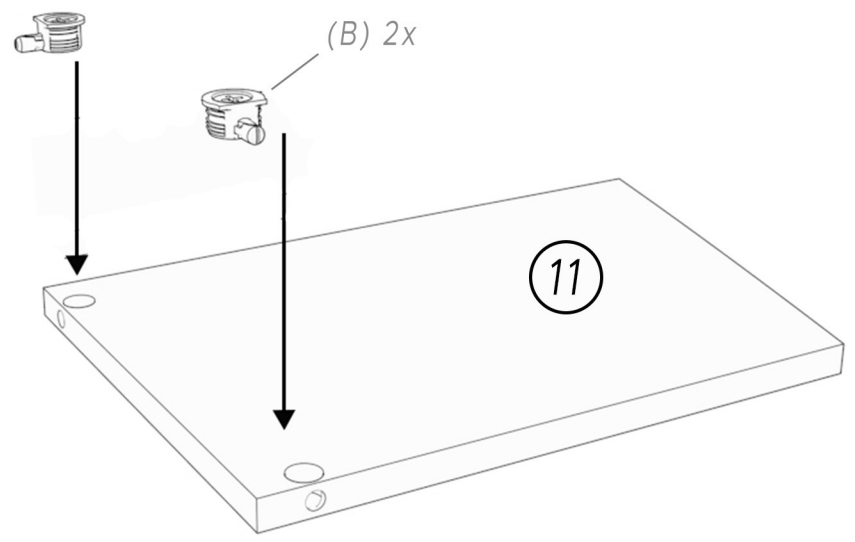

6.b

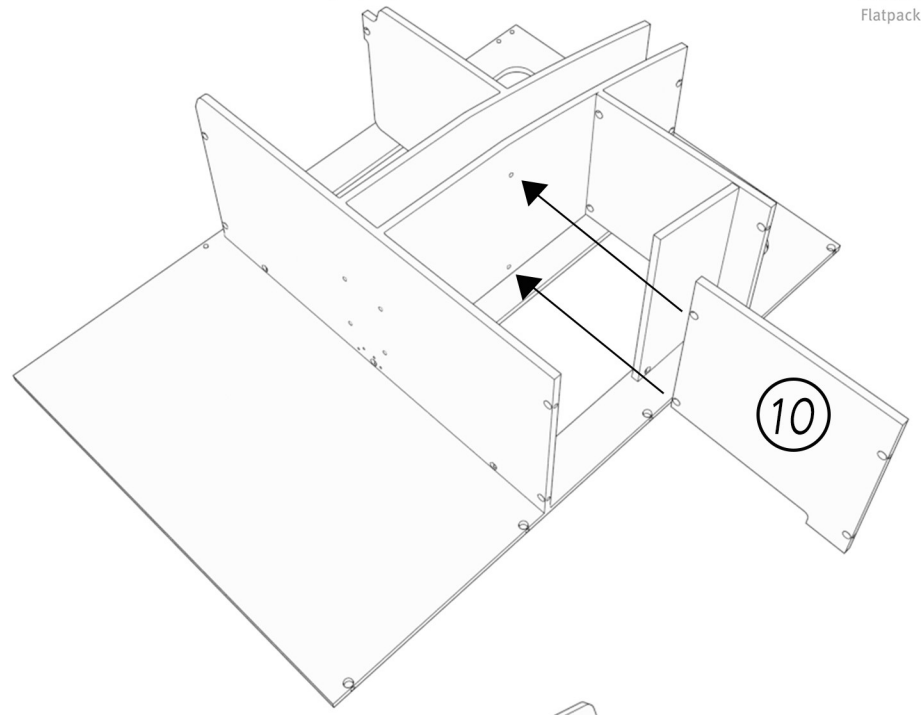

6.c

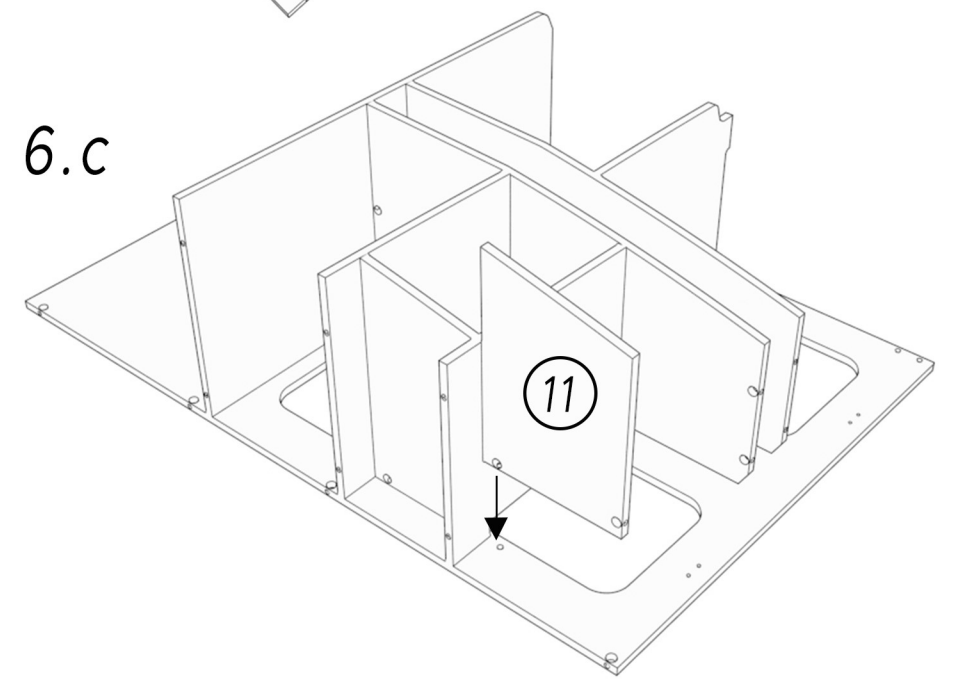

7.

4x (B)
 8x (A)
 4x (K)
 2x (G)
 2x (L)
 2x (M)

7.c

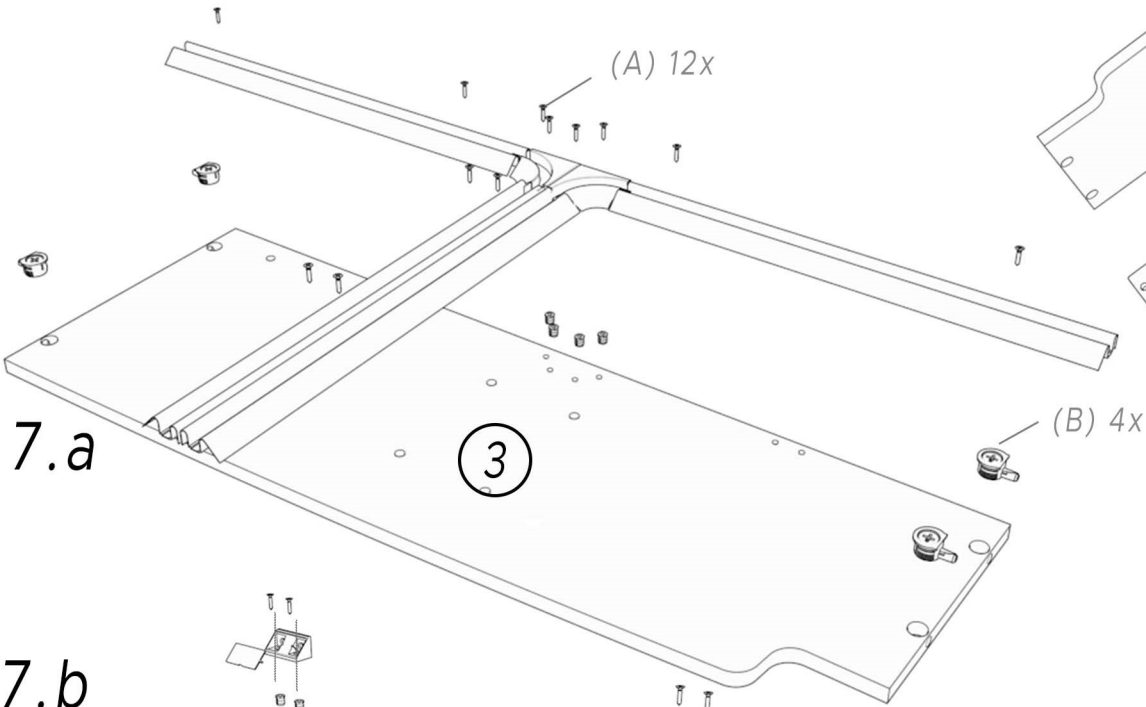

7.b

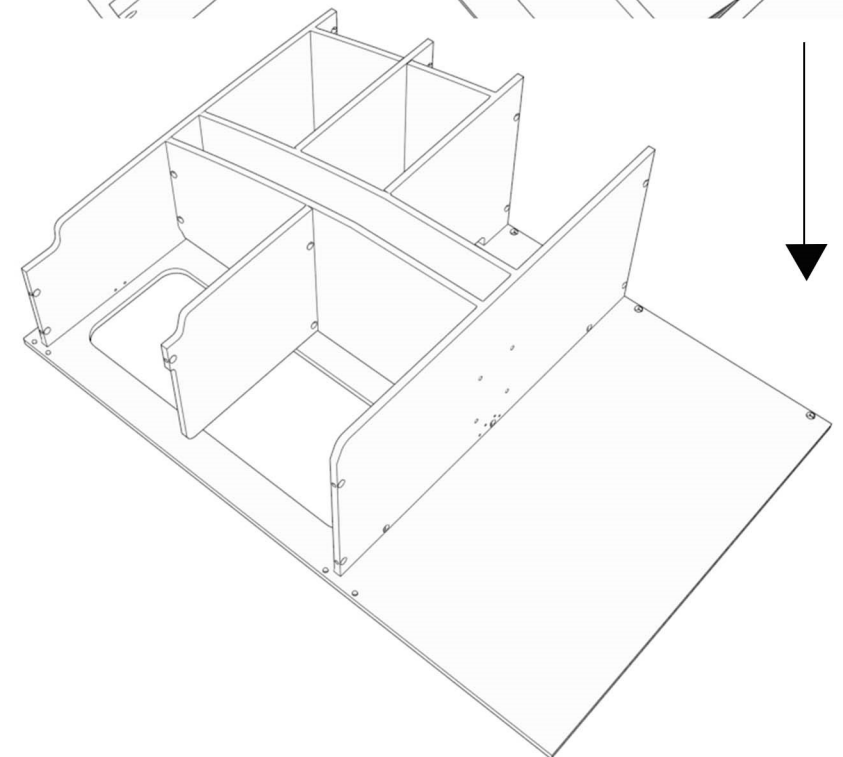
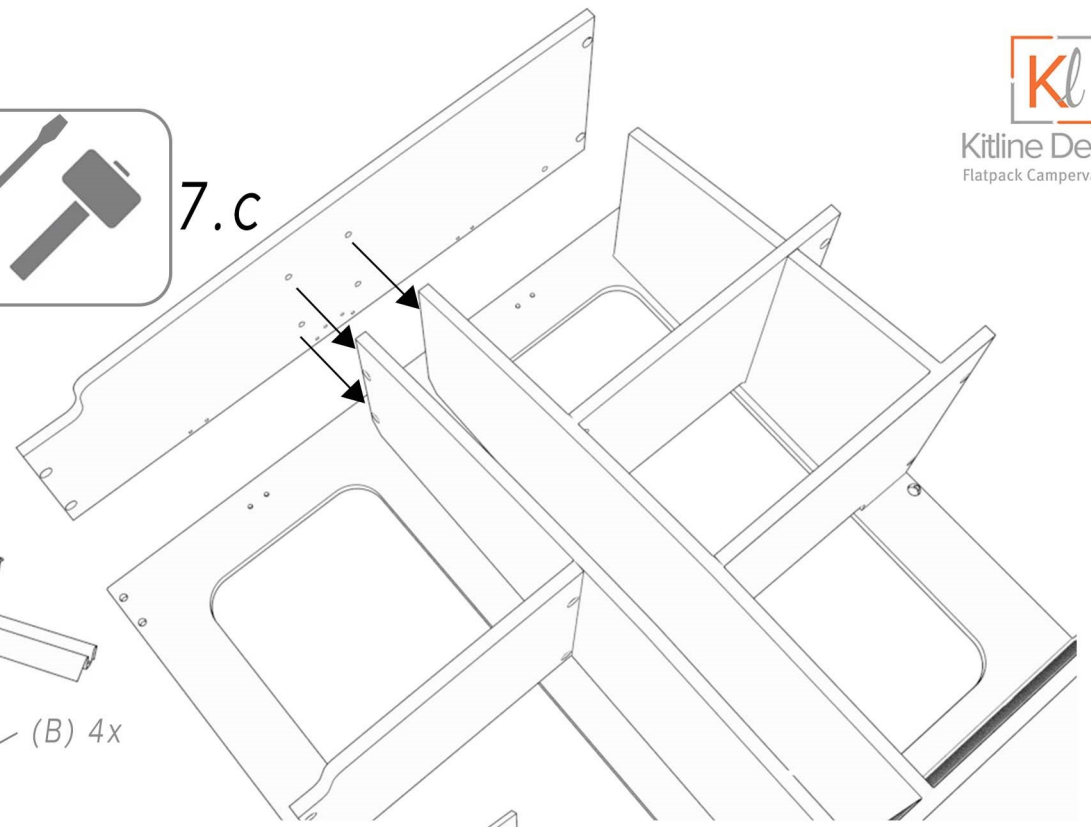
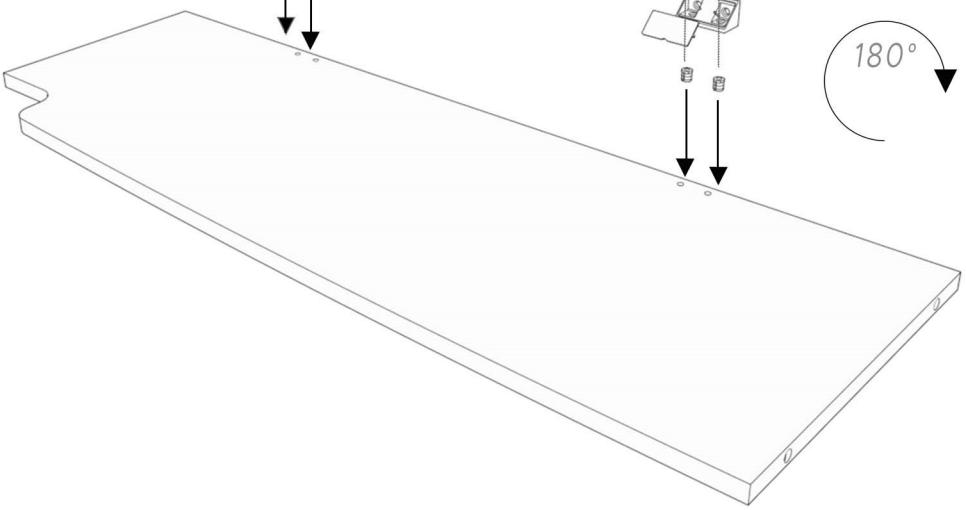

8.

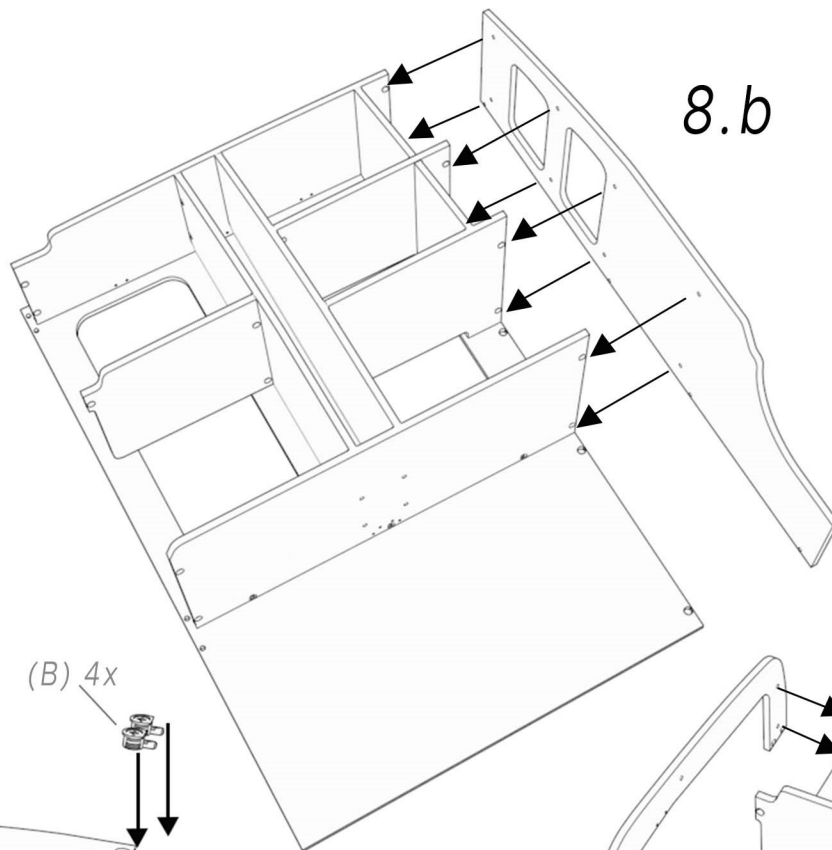
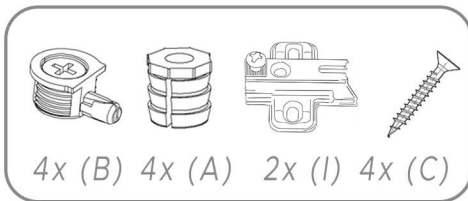

8.a

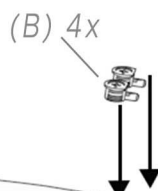
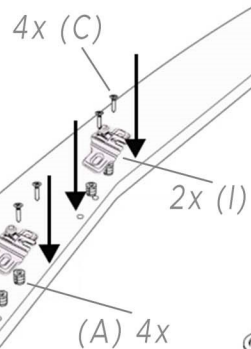

8.c

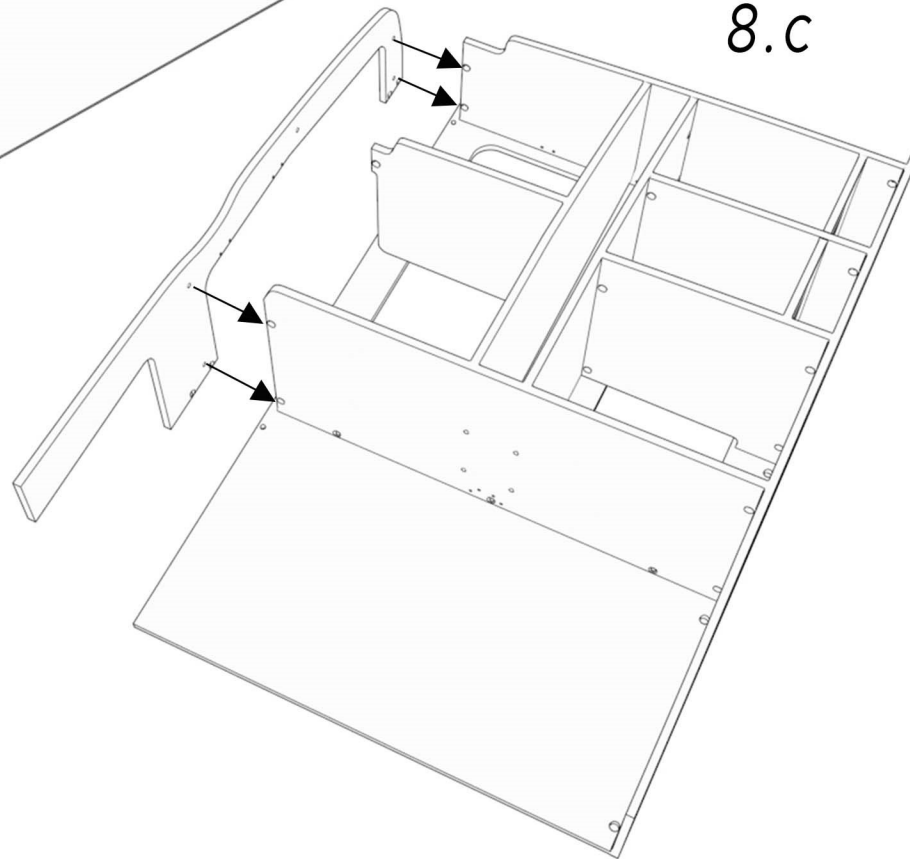

Kitline Design
Flatpack Campervan Units

9.

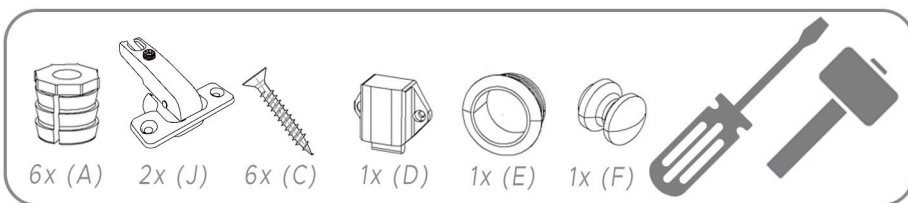

9.a

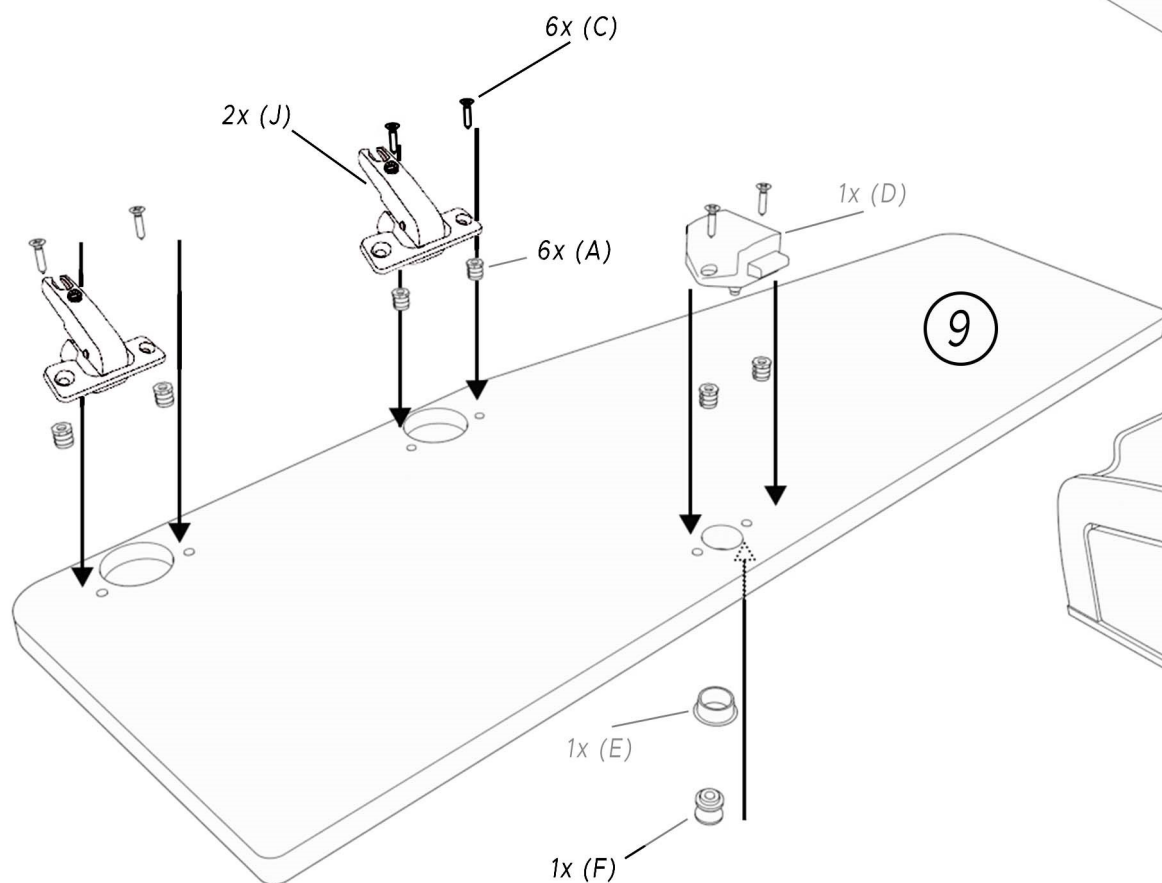

9.b

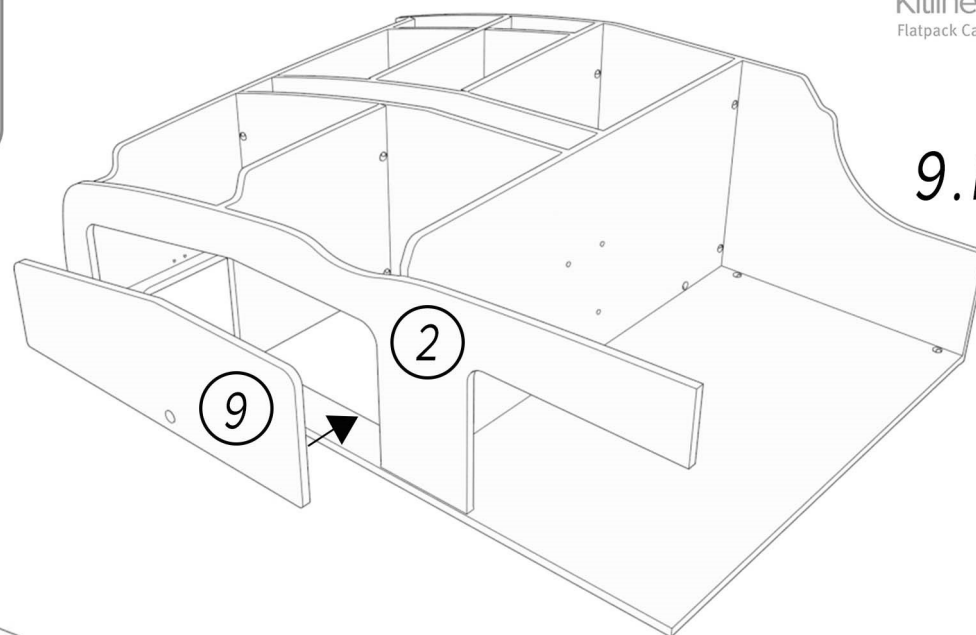

9.c

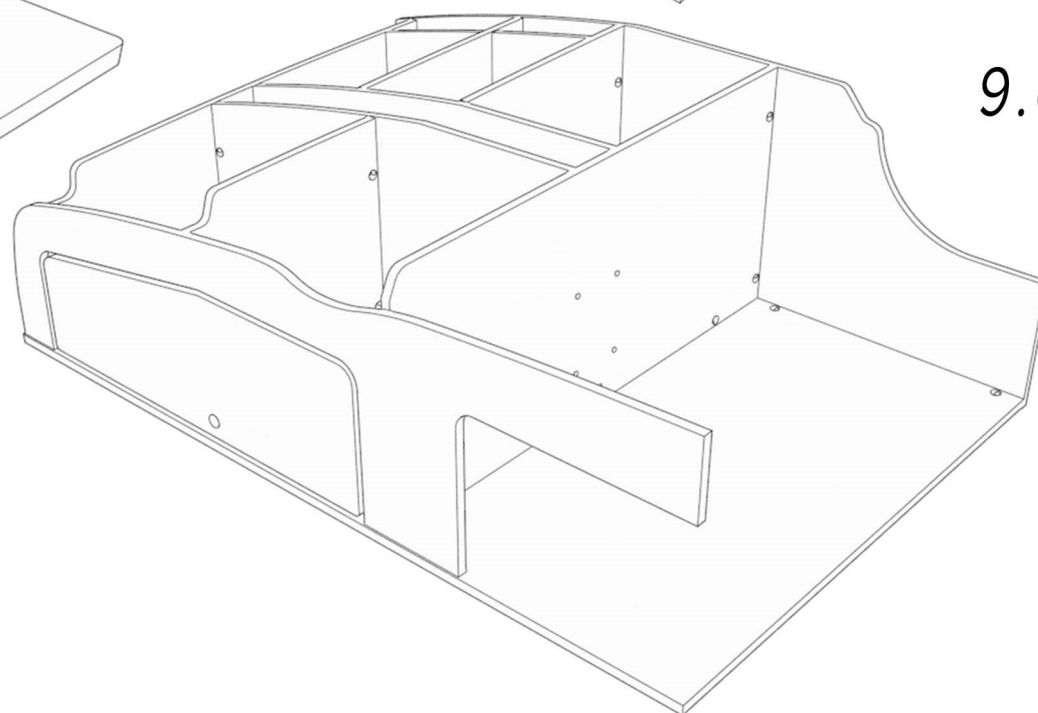

10.

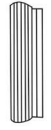

2x (L)

10.a

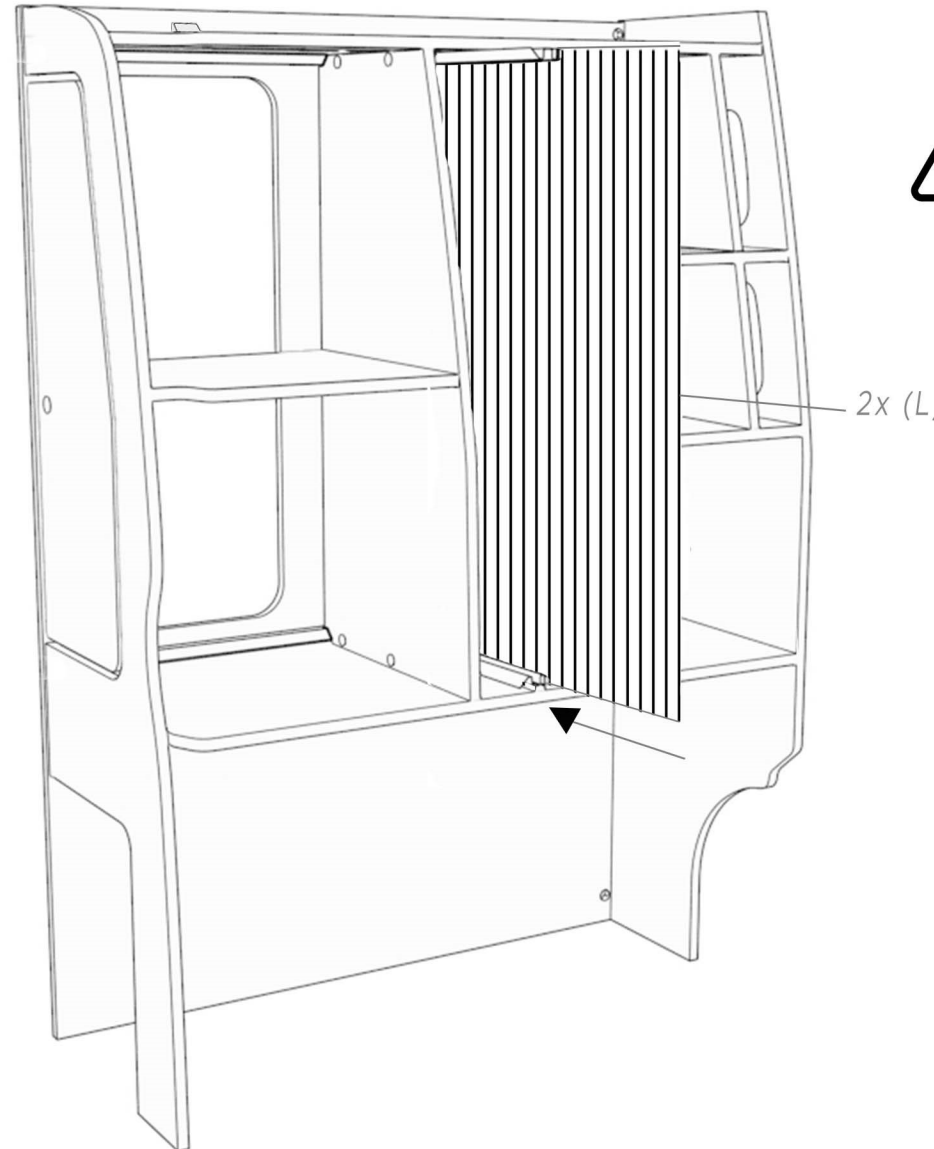

*Tambour doors must be fitted
BEFORE installing the wardrobe
into the van.*