

SWB-curved Coastline

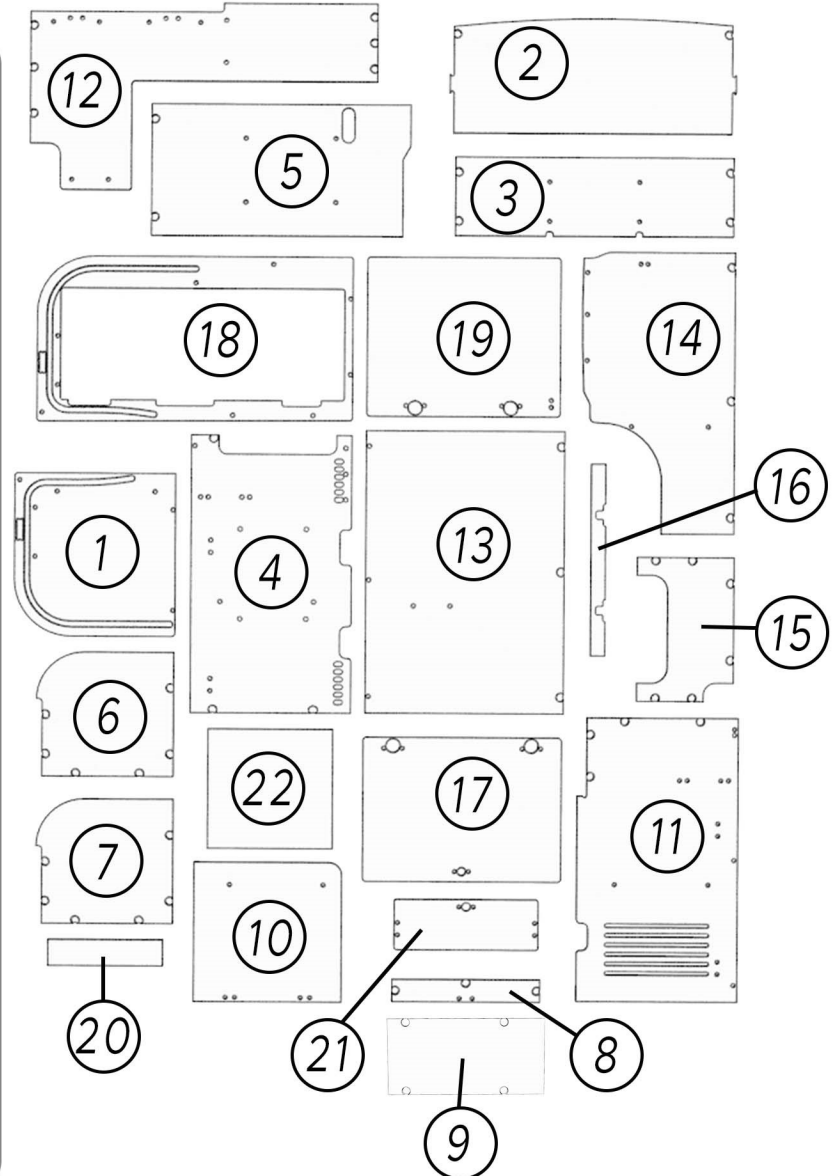

Kitline Design
Flatpack Campervan Units

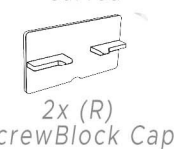

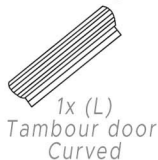
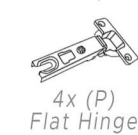
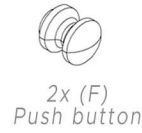
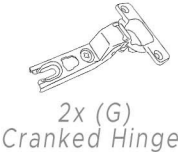
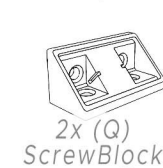
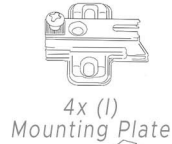
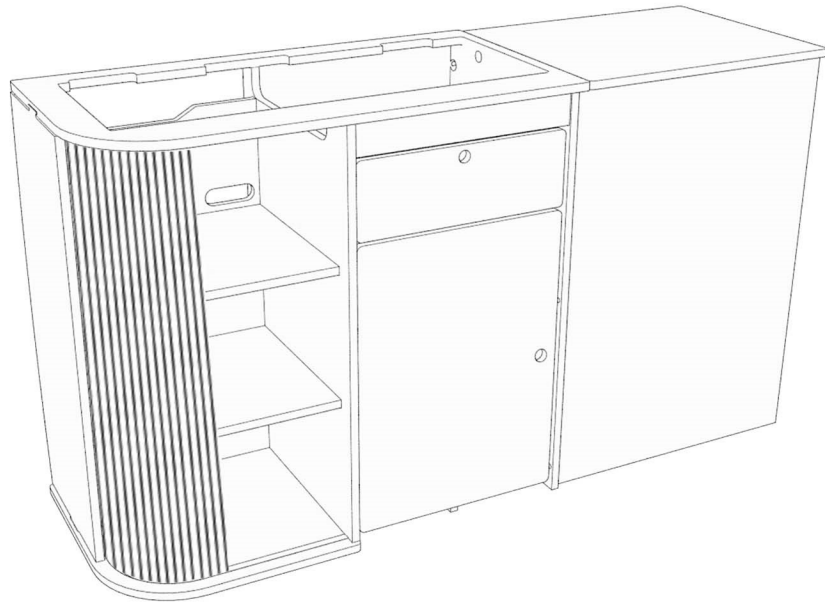
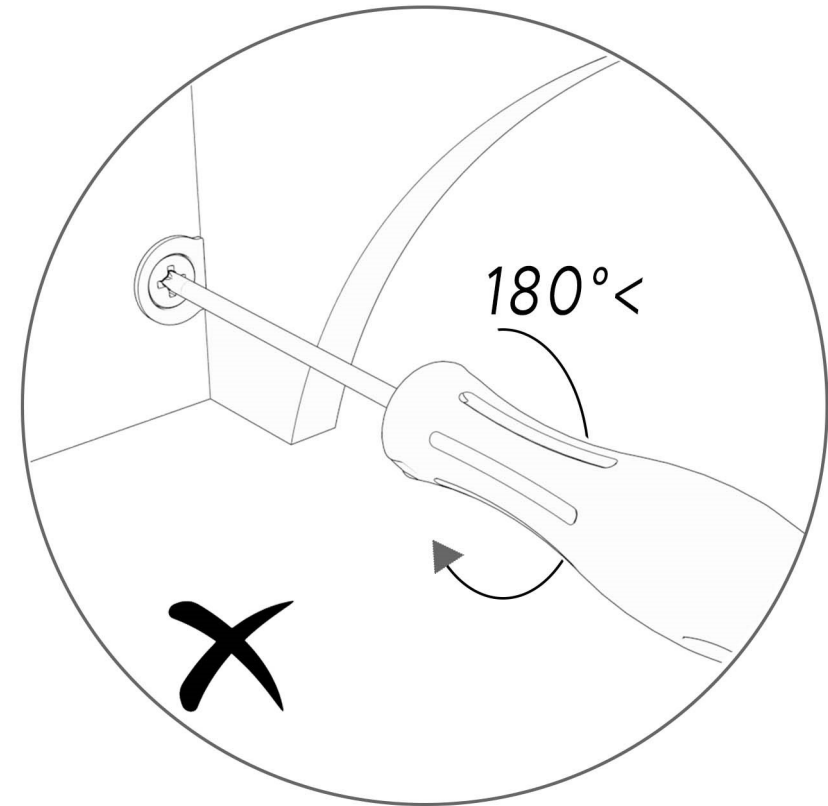
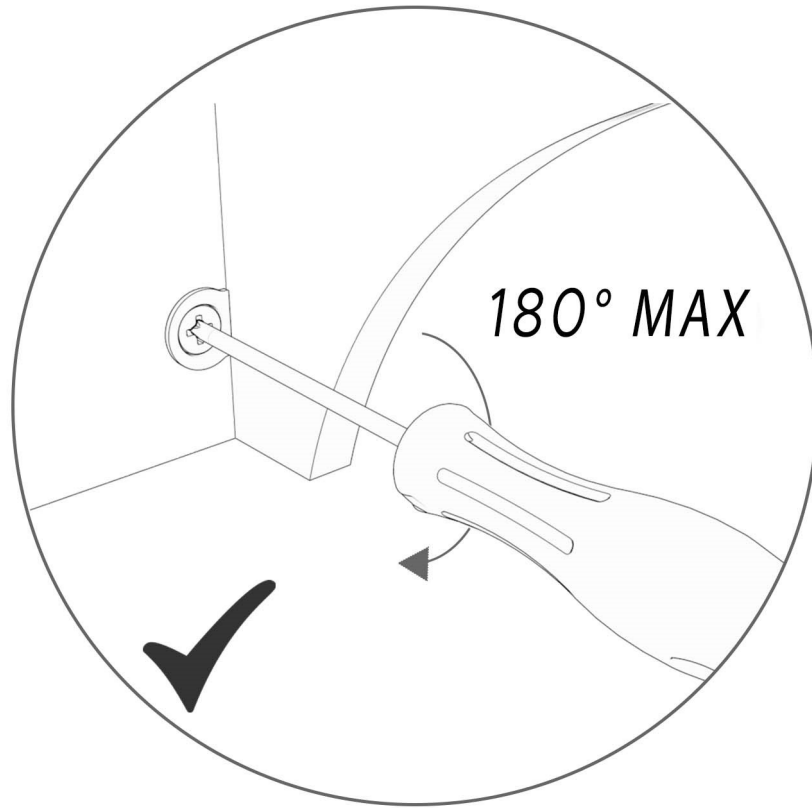

*Do not over tighten Onefix
Connectors!*

1.

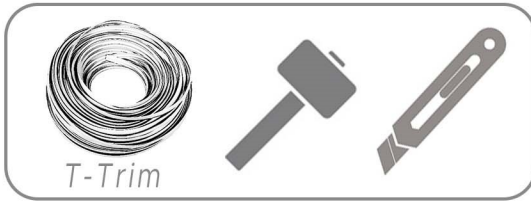

All pieces should have T-Trim applied before assembly!

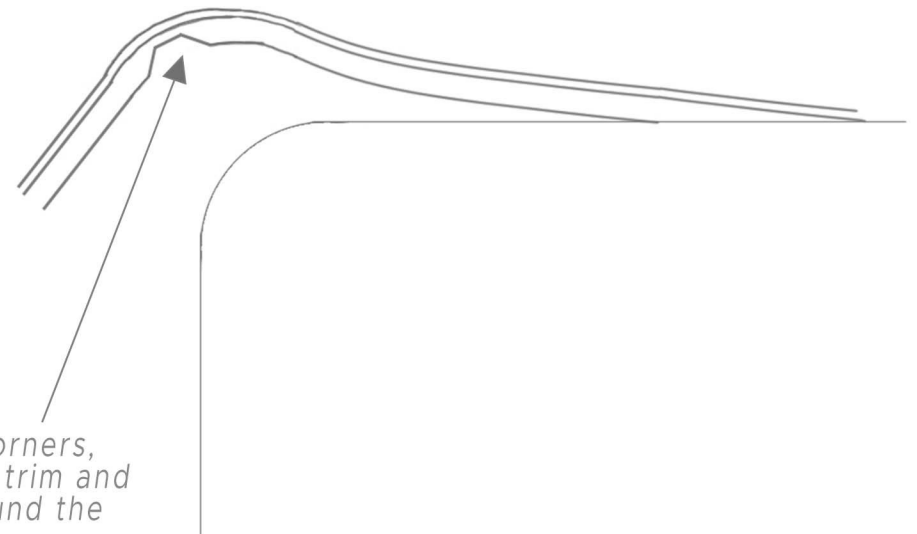
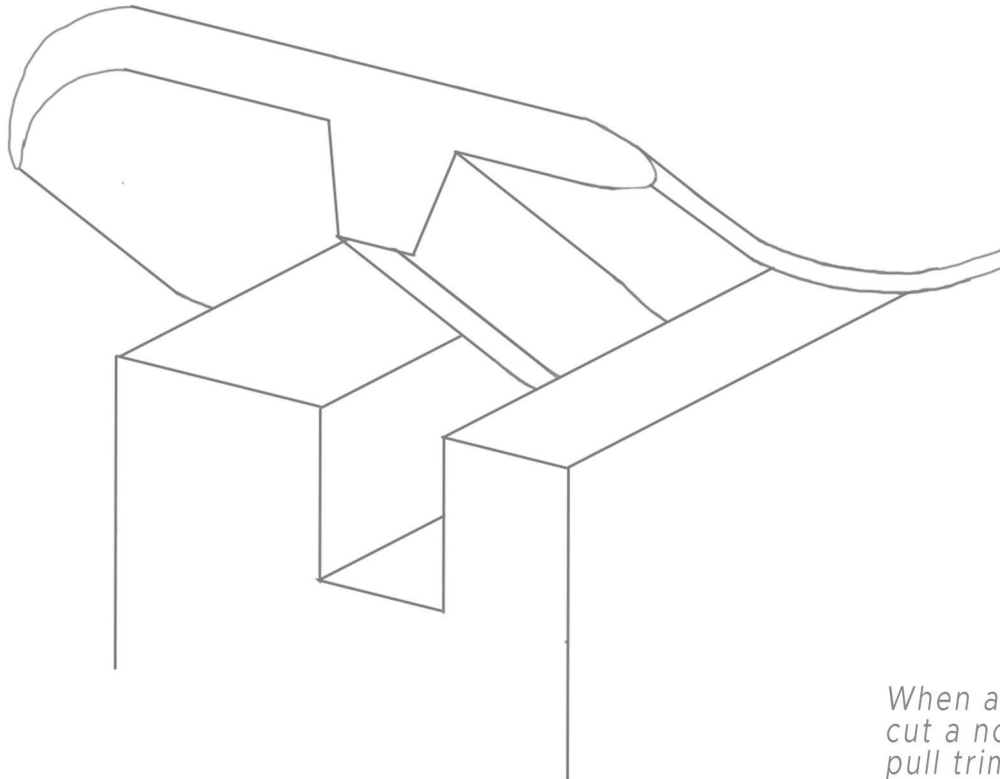
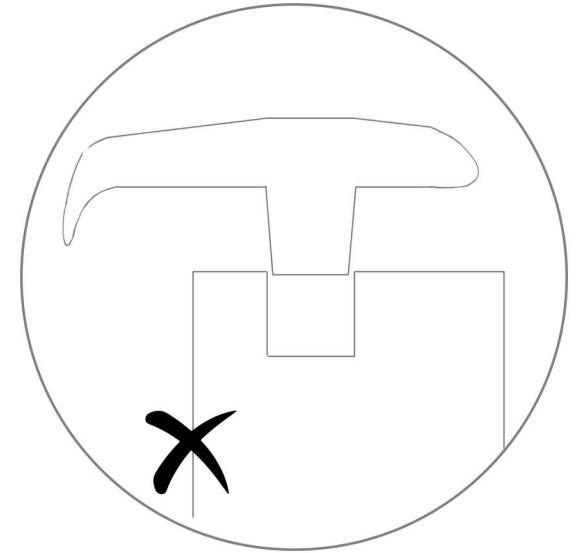
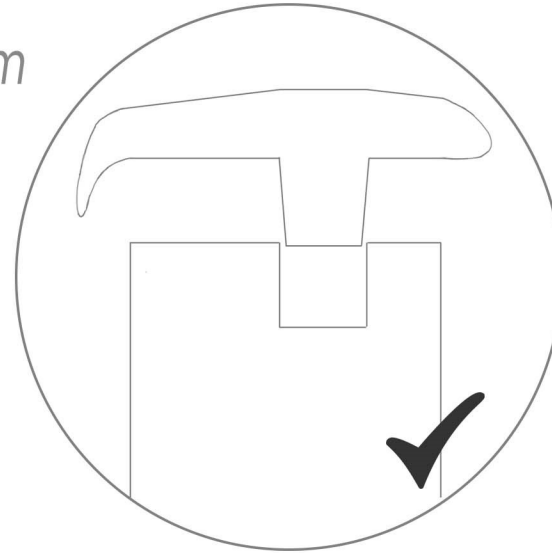

When applying to corners, cut a notch into the trim and pull trim tightly around the corner.



4x (B)

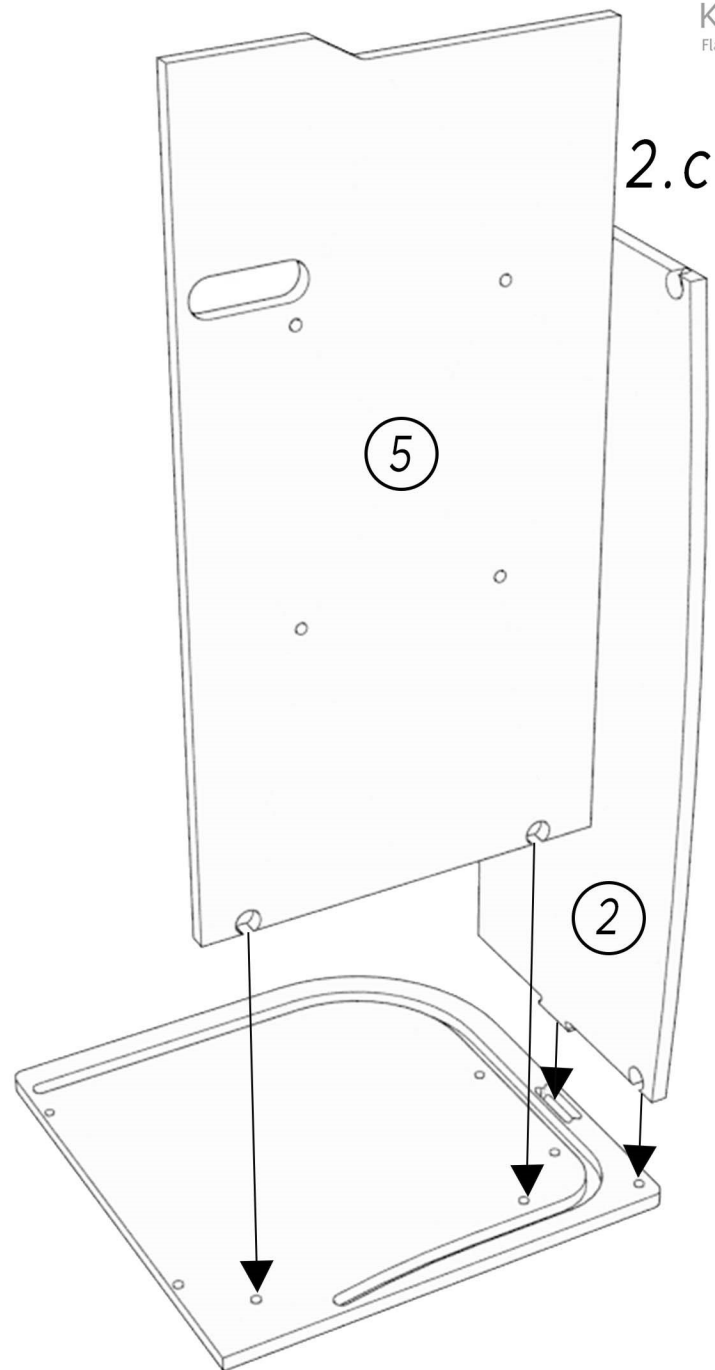

3.

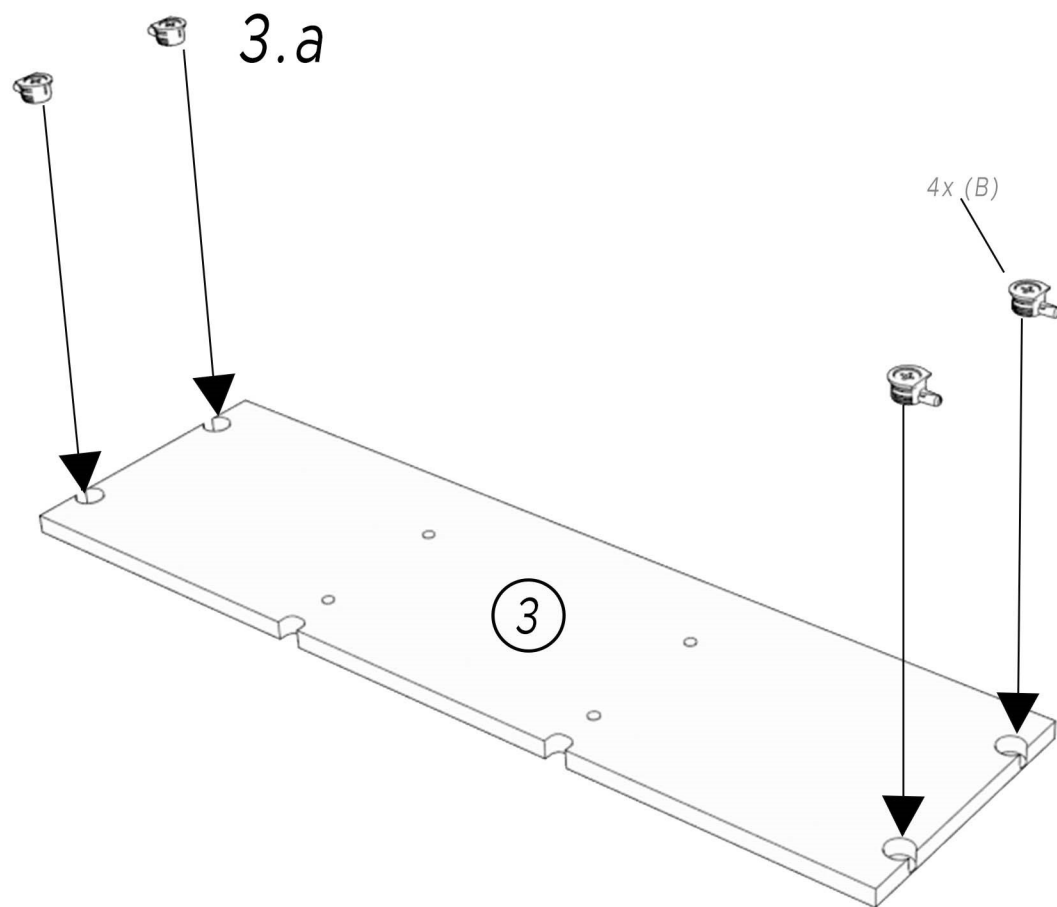
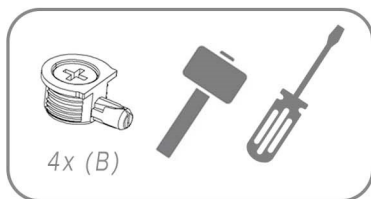

3.b

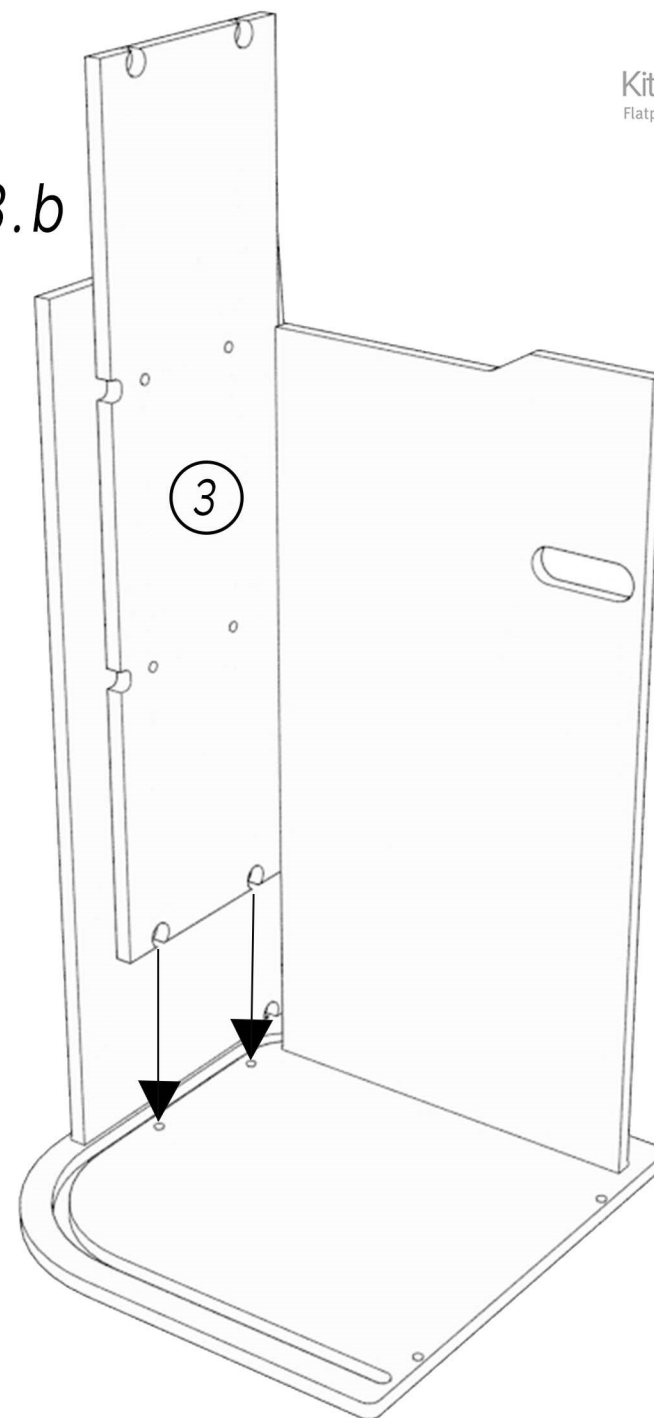

4.

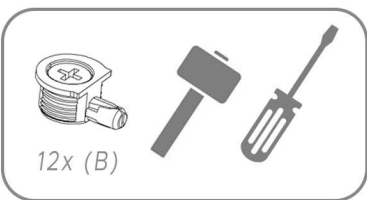

4.a

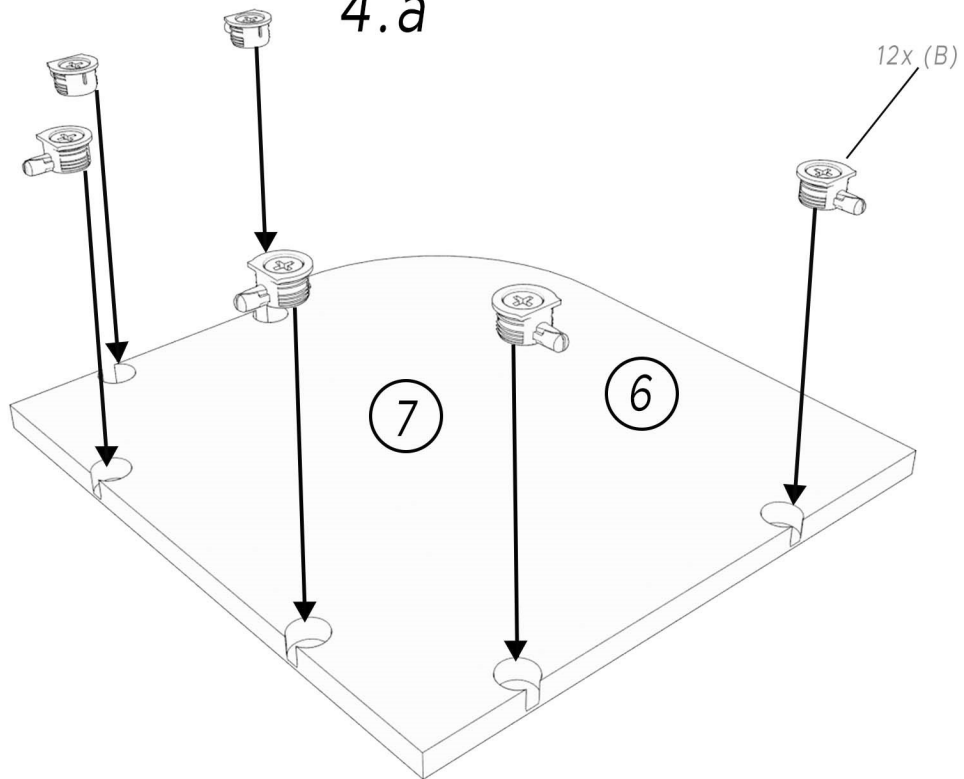

4.b

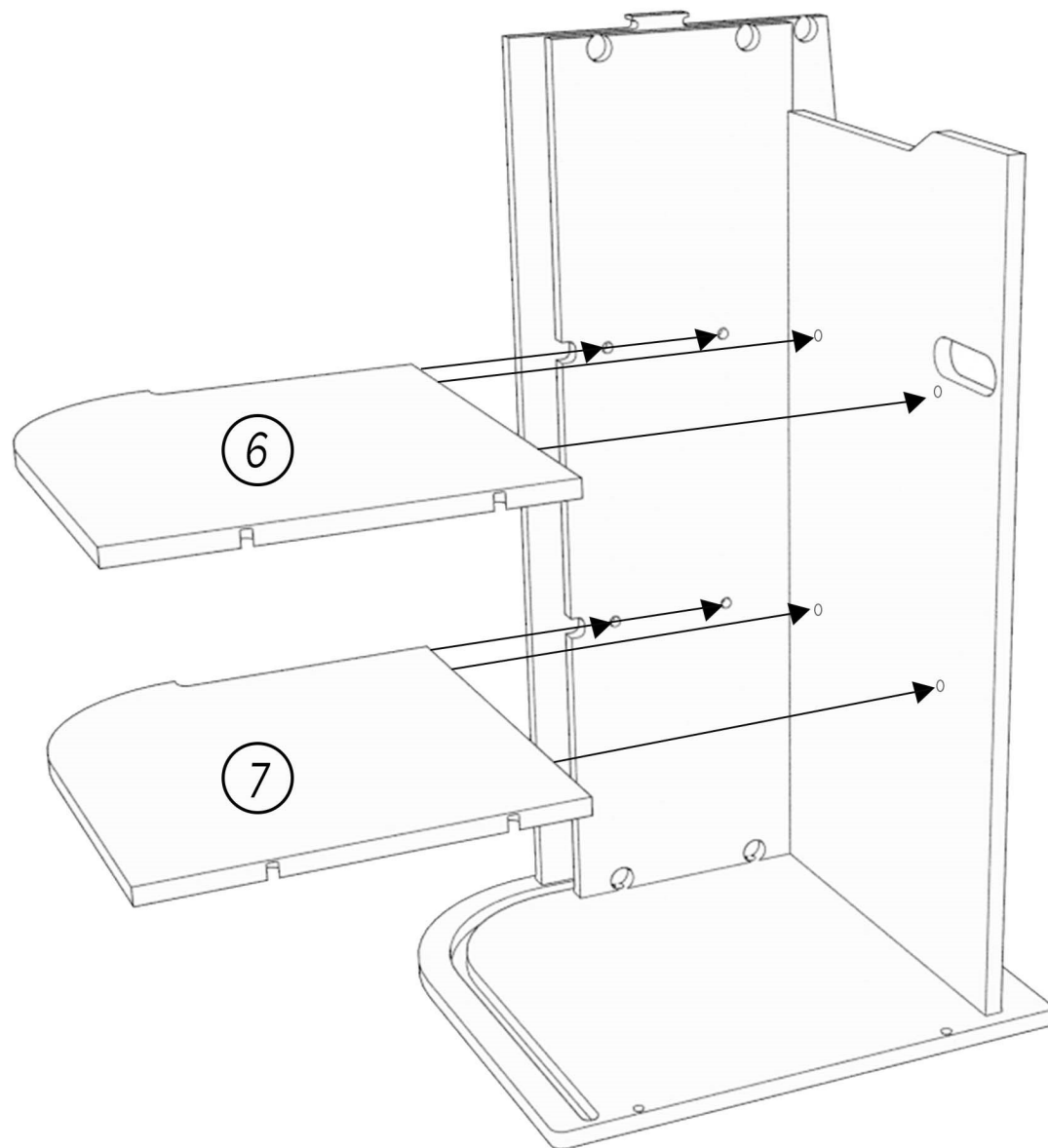

Kitline Design
Flatpack Campervan Units

5.

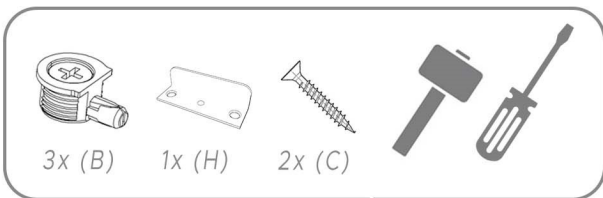

5.a

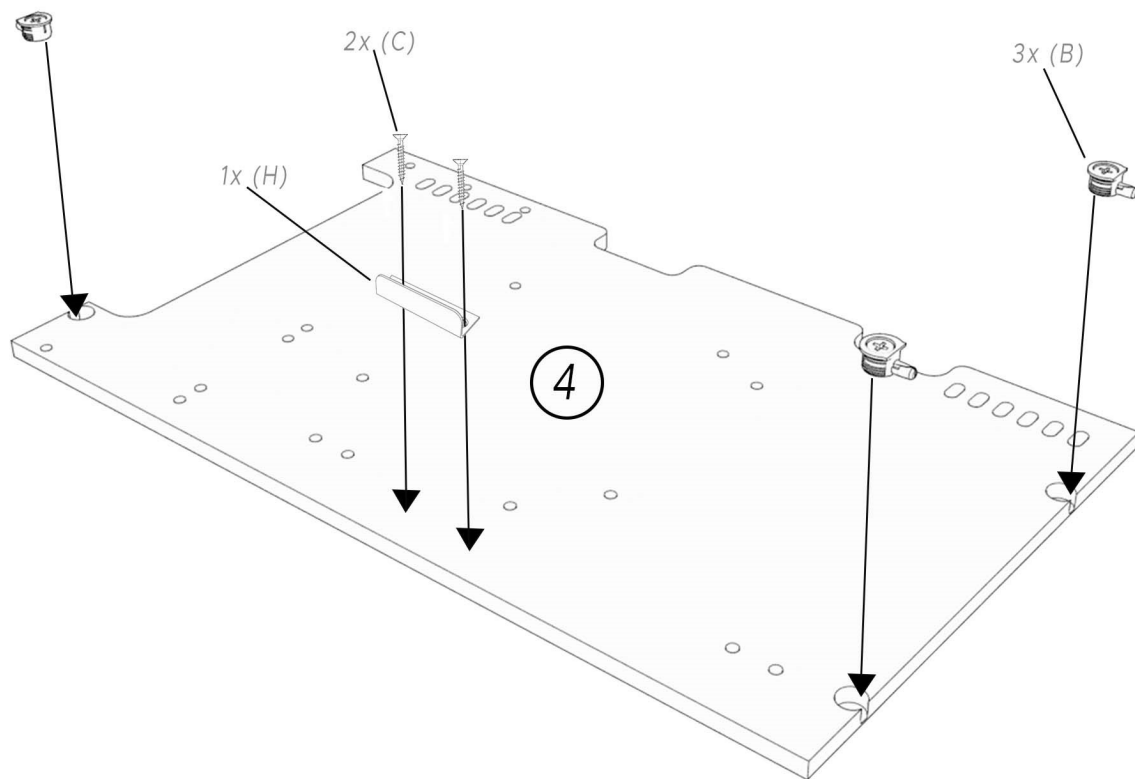

5.b

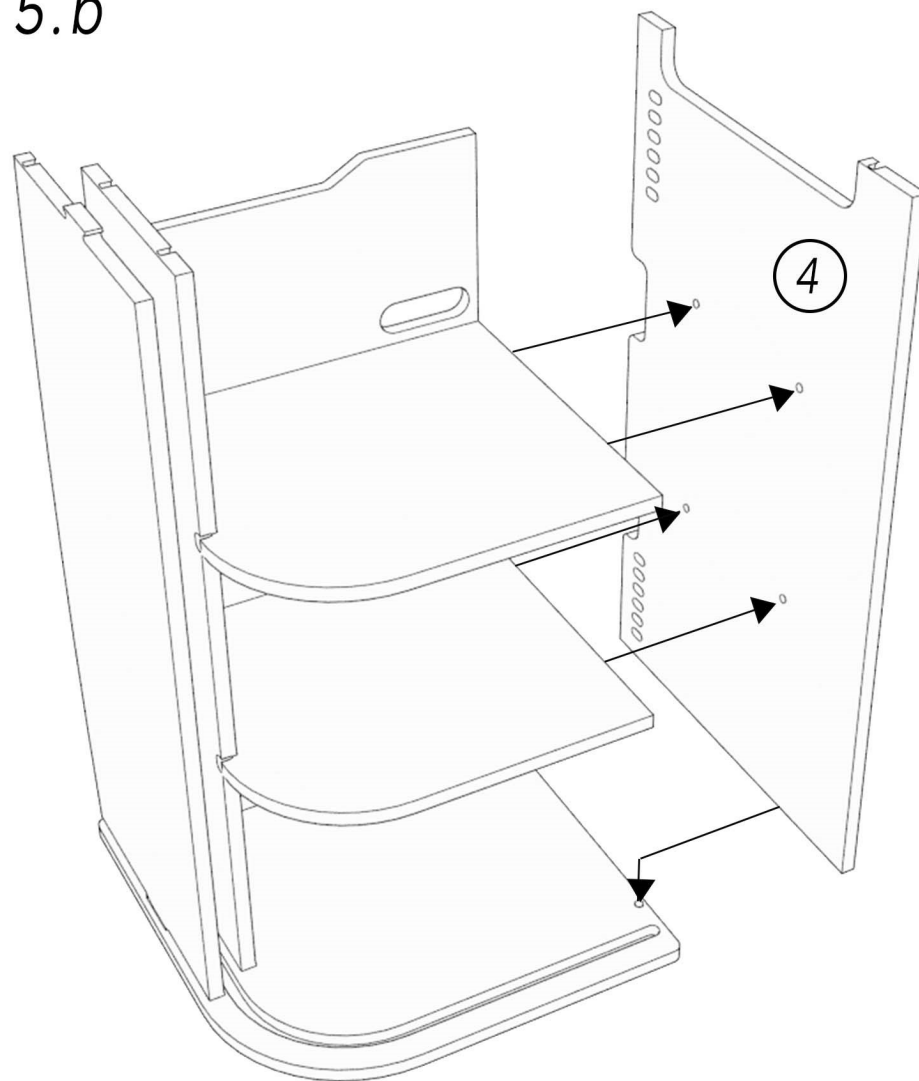

6.



3x (B)



8x (A)



8x (C)



1x (D)



1x (E)



1x (F)

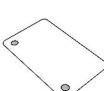

1x (M)



2x (G)



6.a

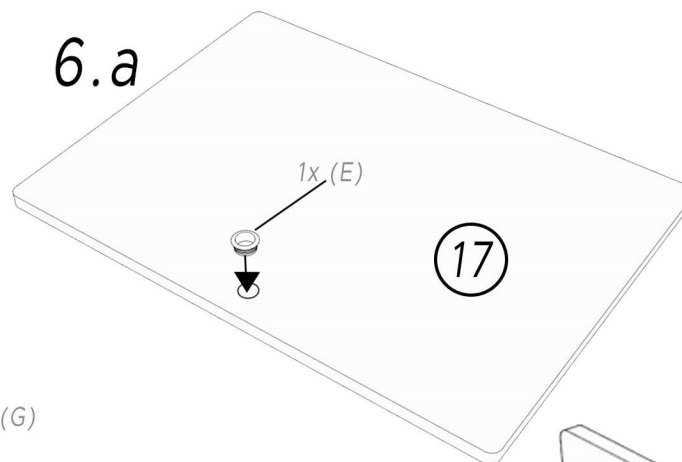

6.b

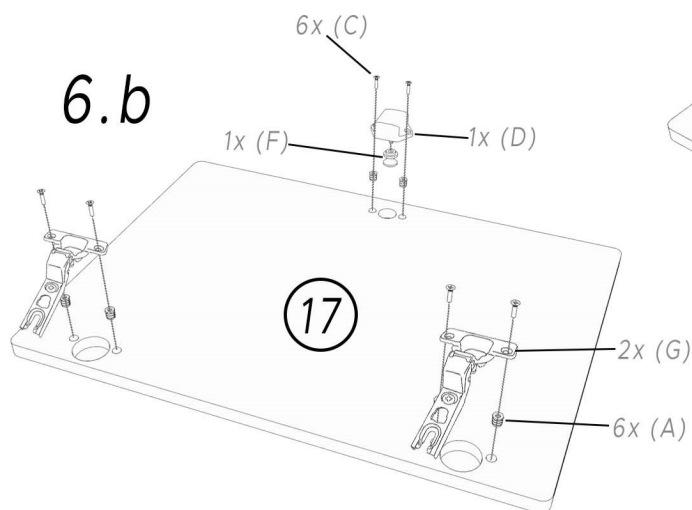

6.d

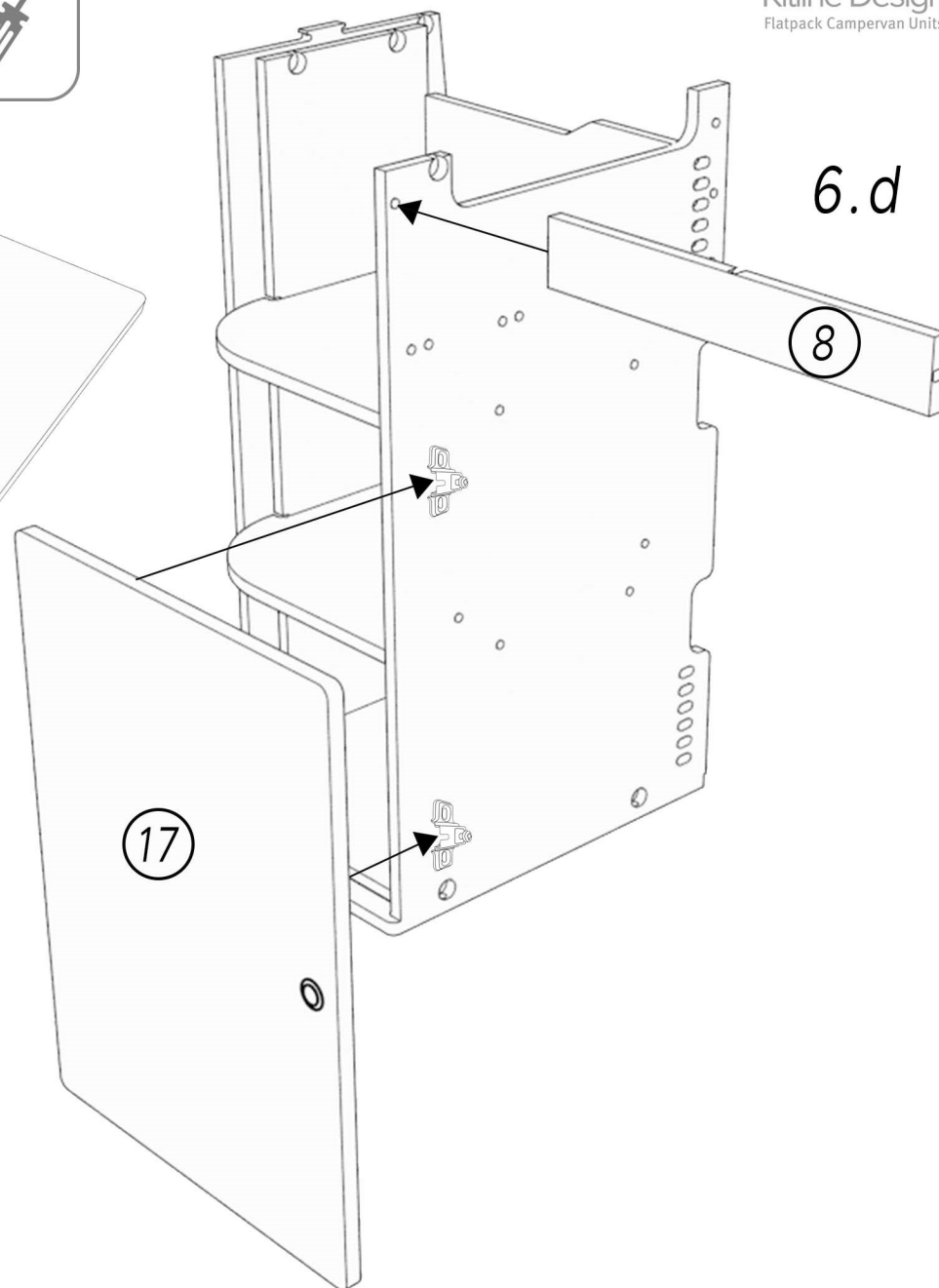

6.c

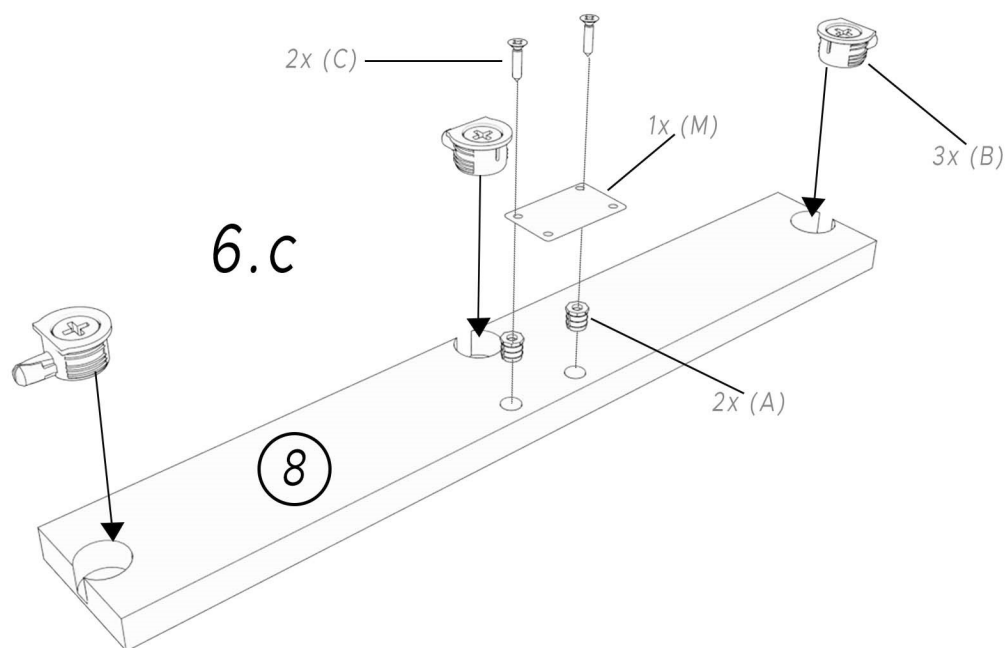

7.



4x (B)



4x (A)



2x (Q)

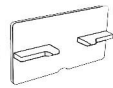

2x (R)



4x (C)



7.c

7.a

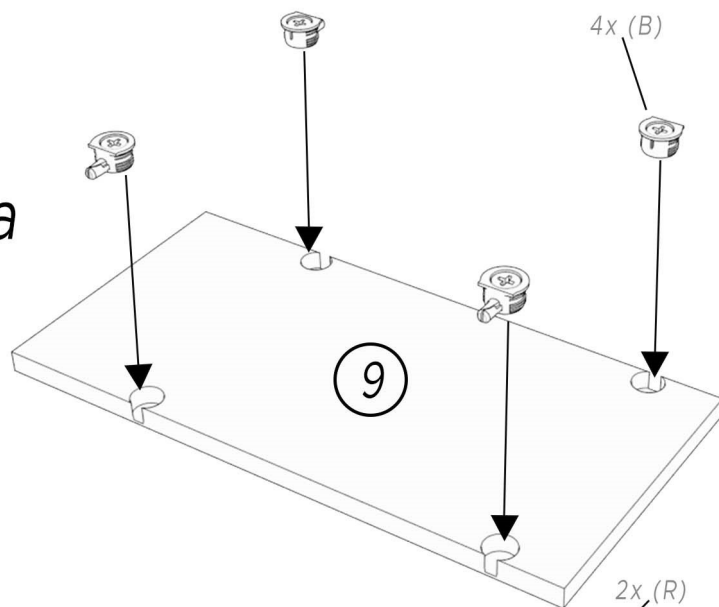

7.b

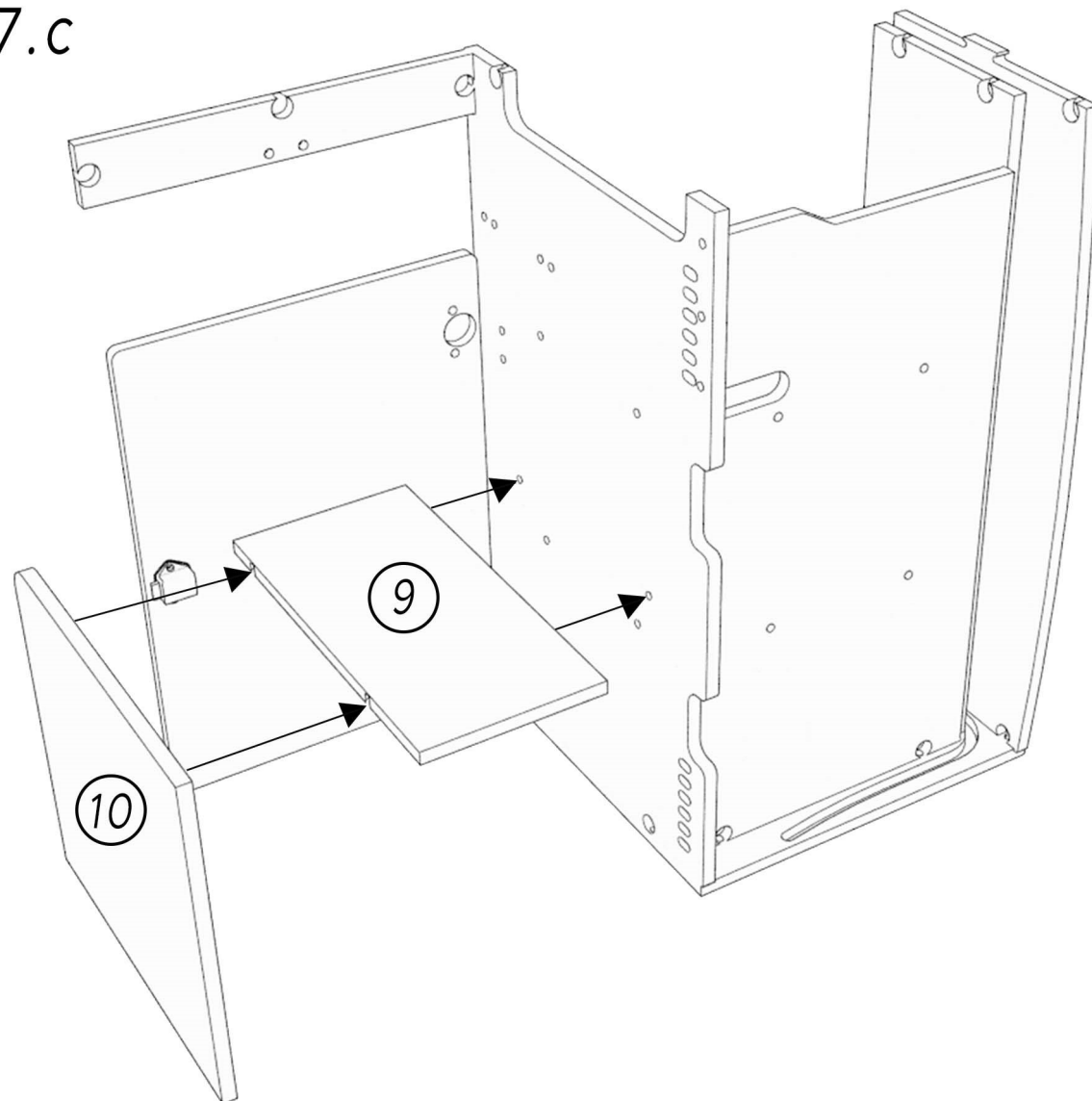
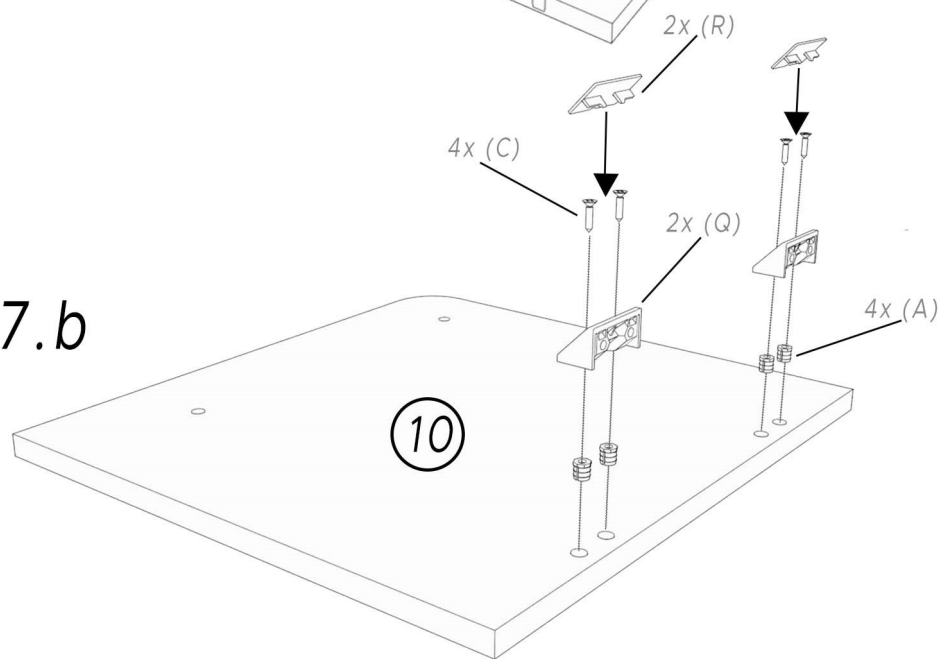

8.



10x (B)



4x (A)

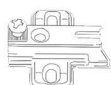

2x (I)



35x (C)



8.a

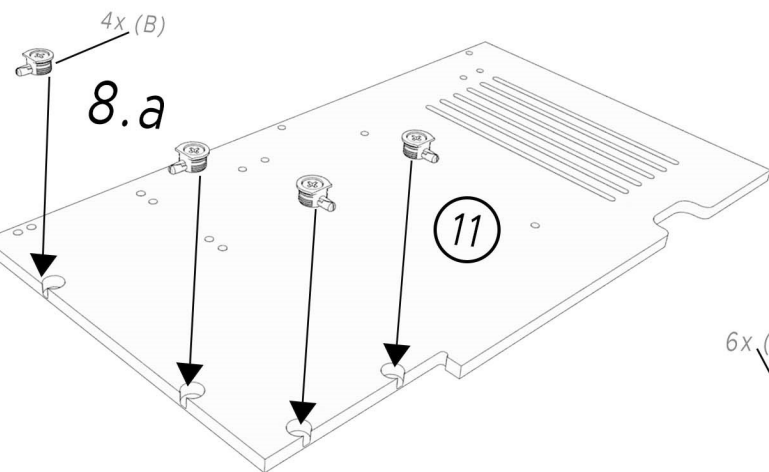

8.b

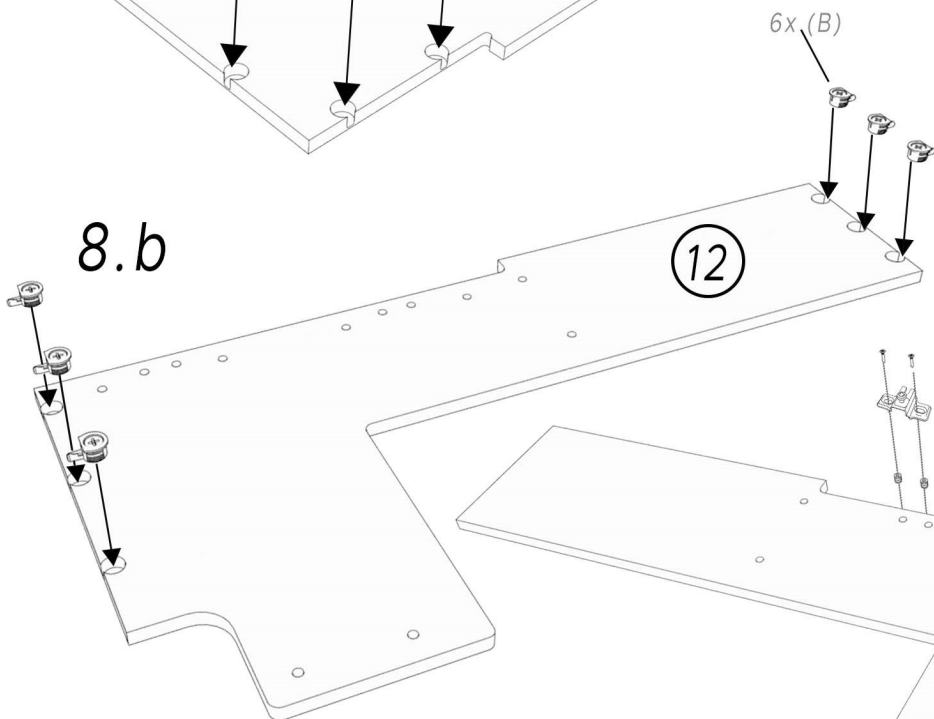

8.c

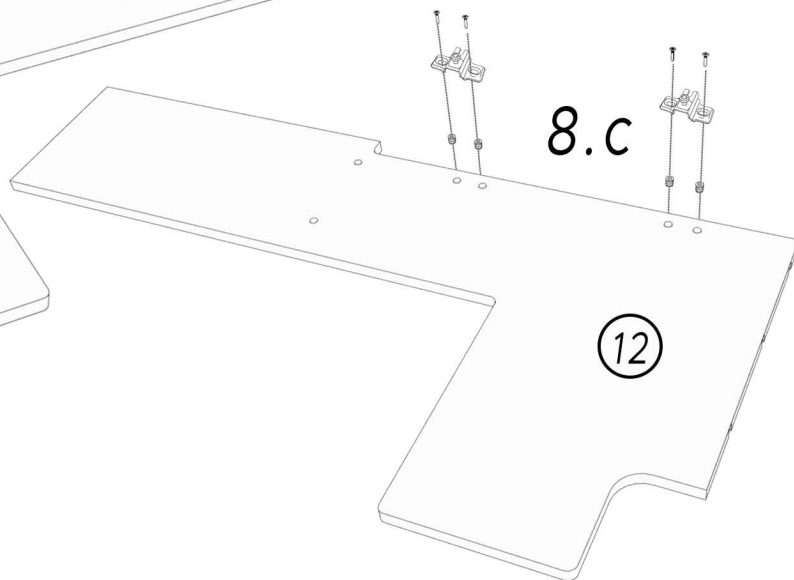

8.d

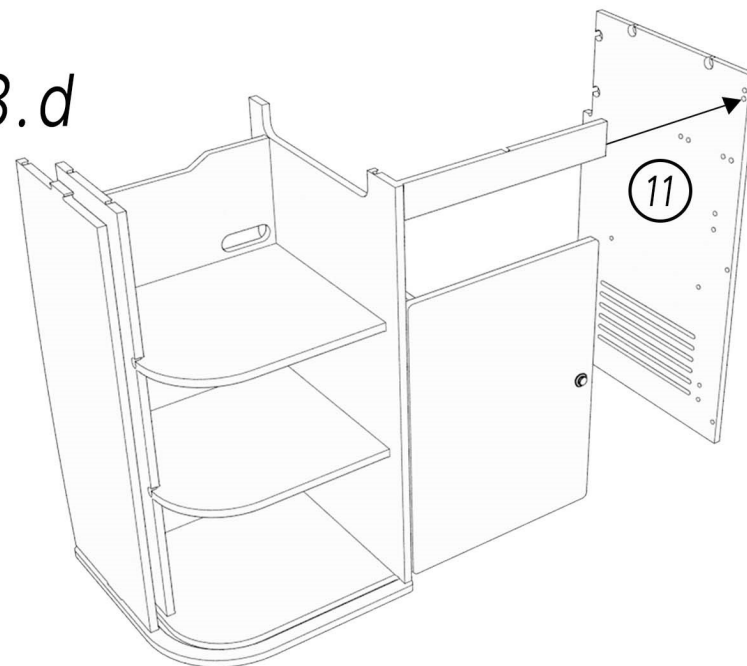

8.e

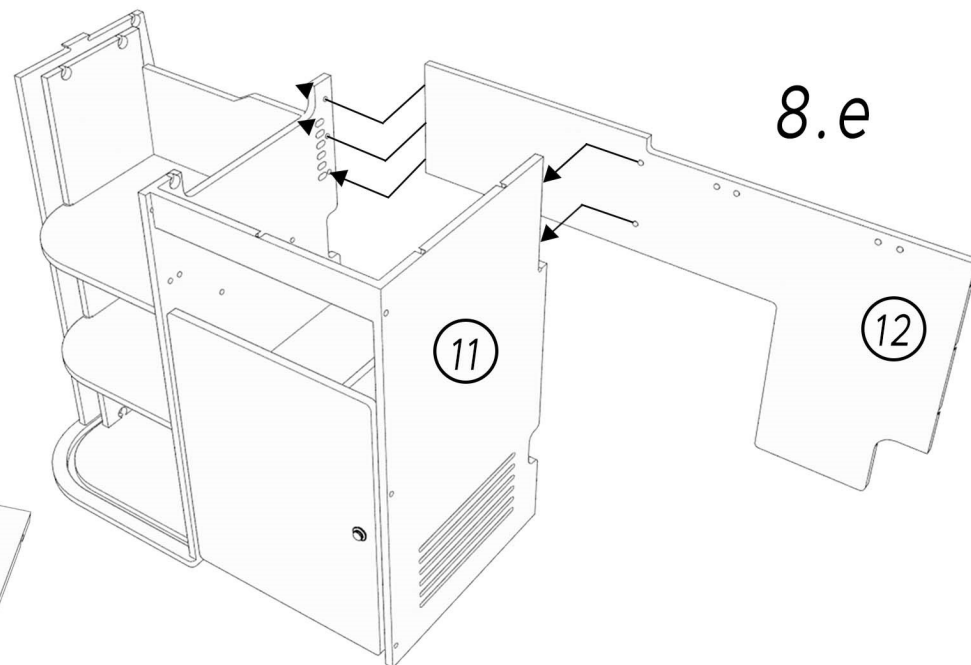

Kitline Design
Flatpack Campervan Units

9.

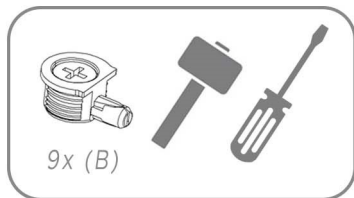

9.a

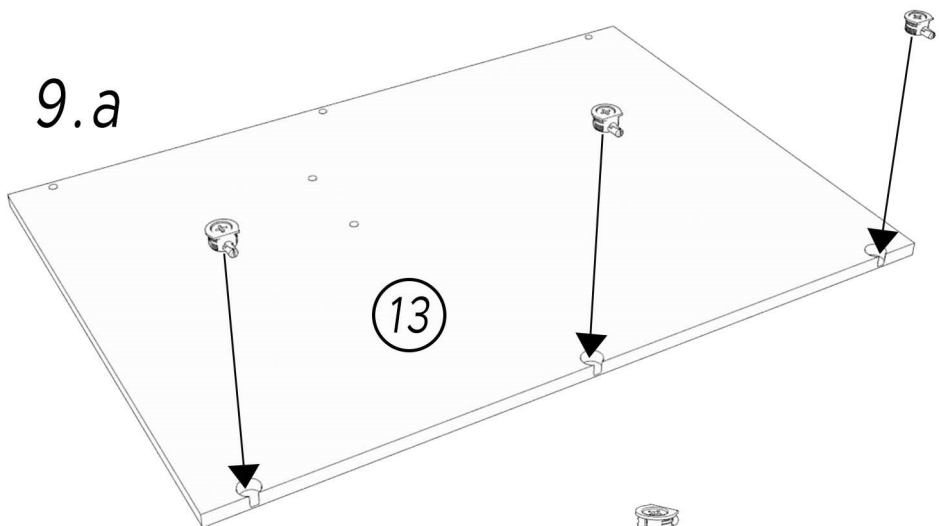

9.b

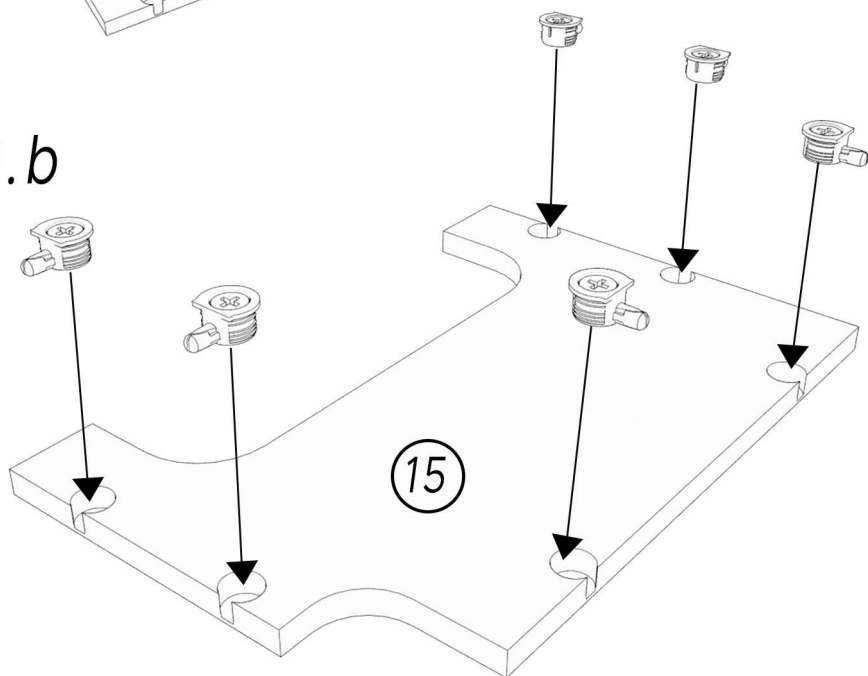

9.c

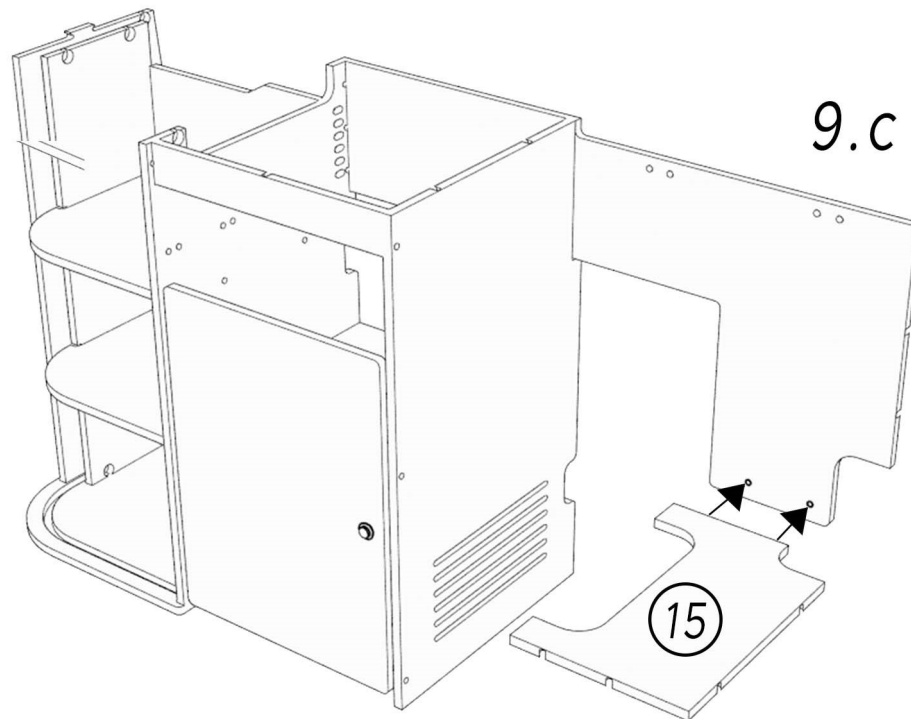

9.d

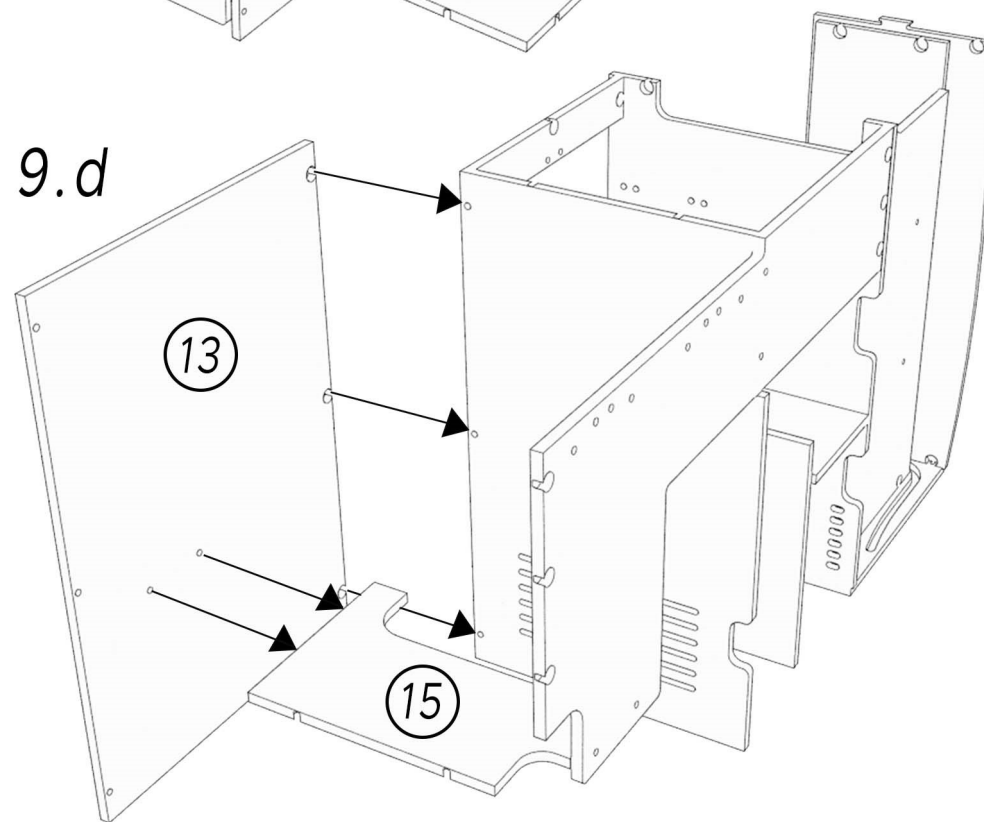

10.

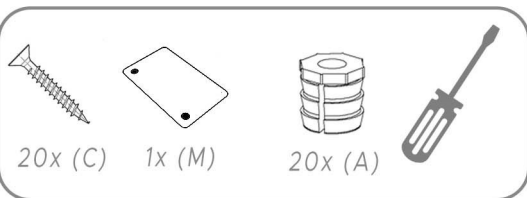

10.a

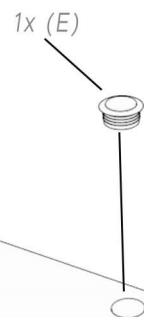

10.c

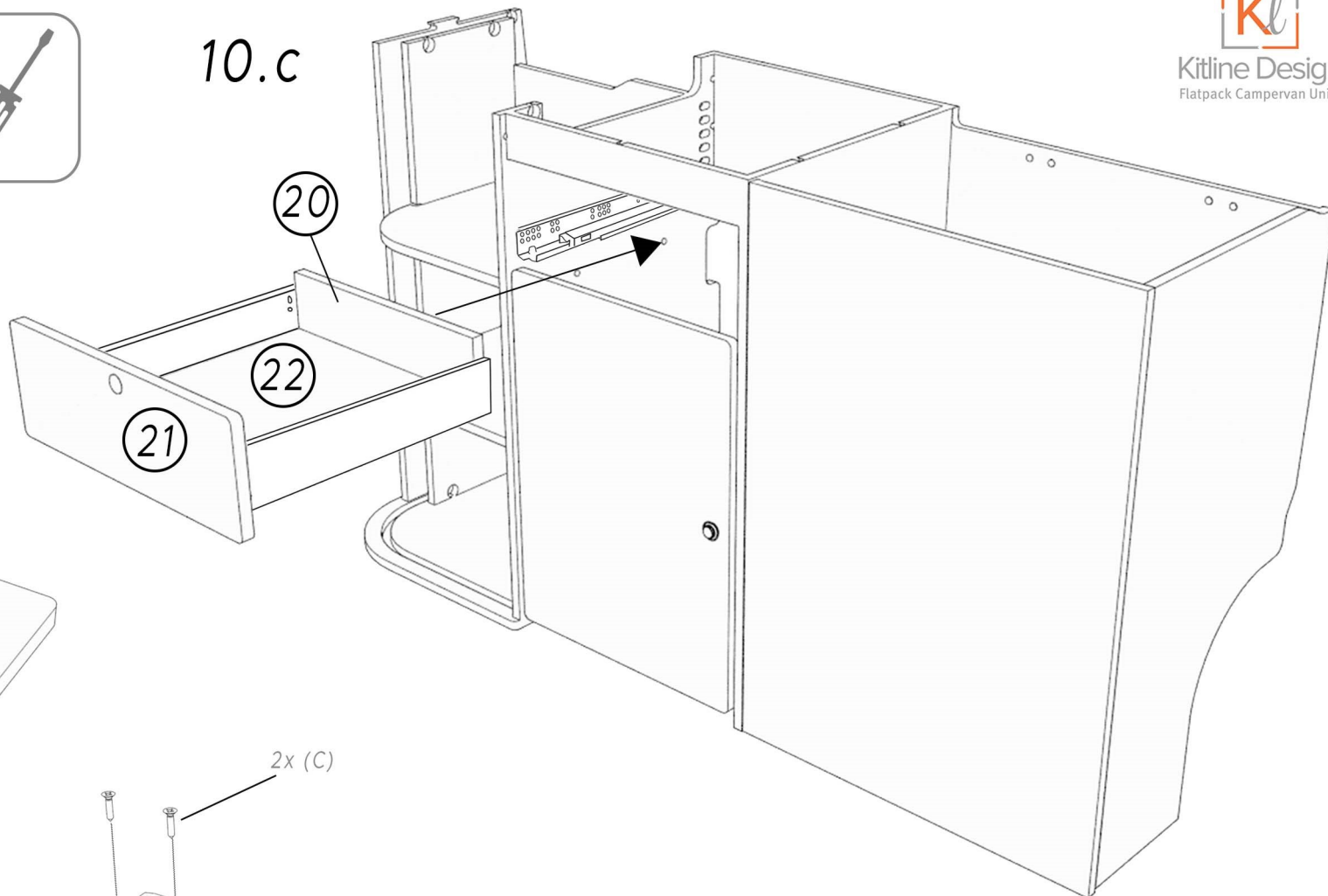

10.b

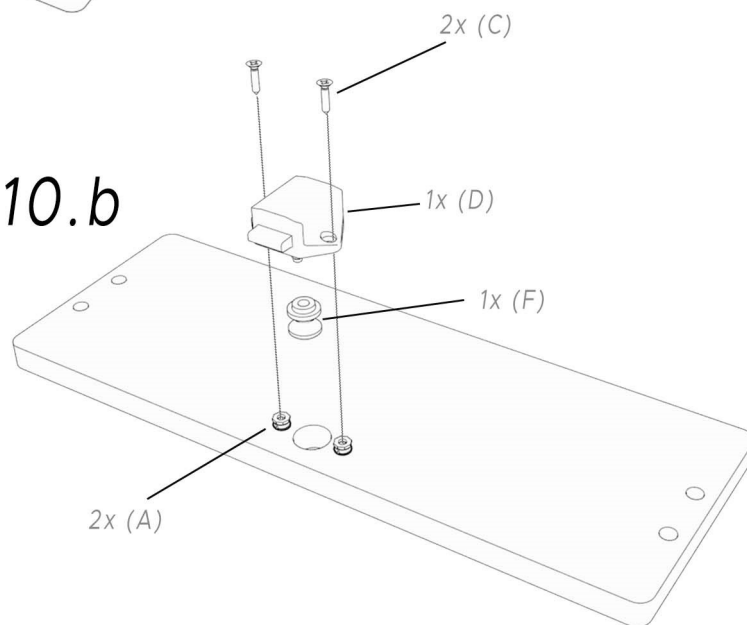

Assemble drawer using manufacturer's instructions provided with drawer set.

11.



4x (A)



4x (C)

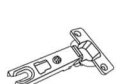

2x (P)



11.a

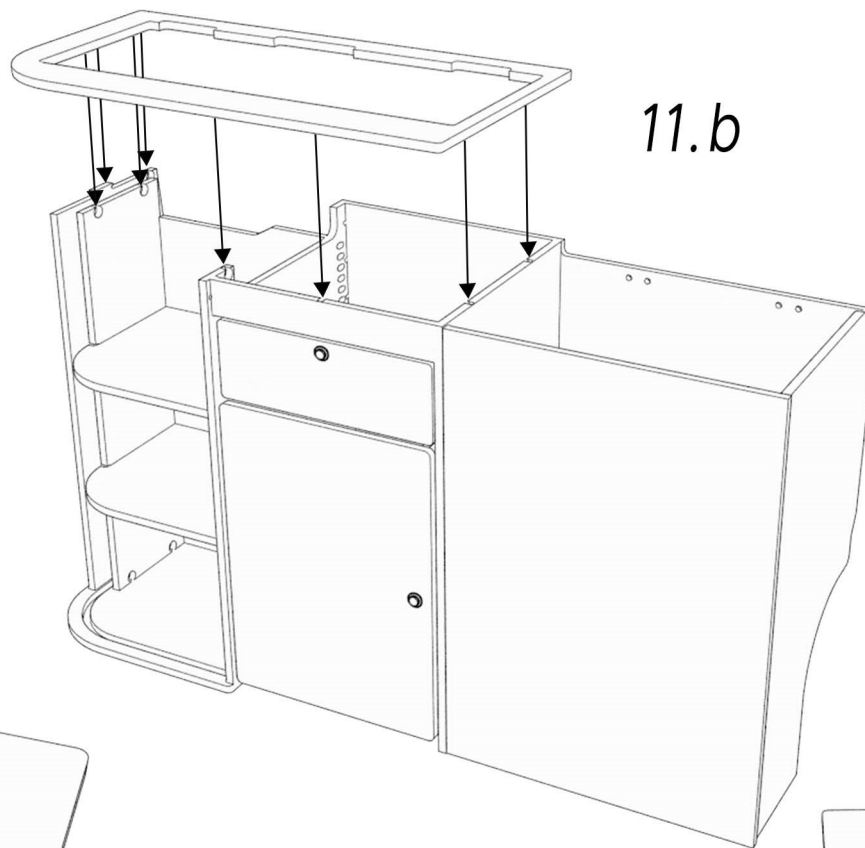
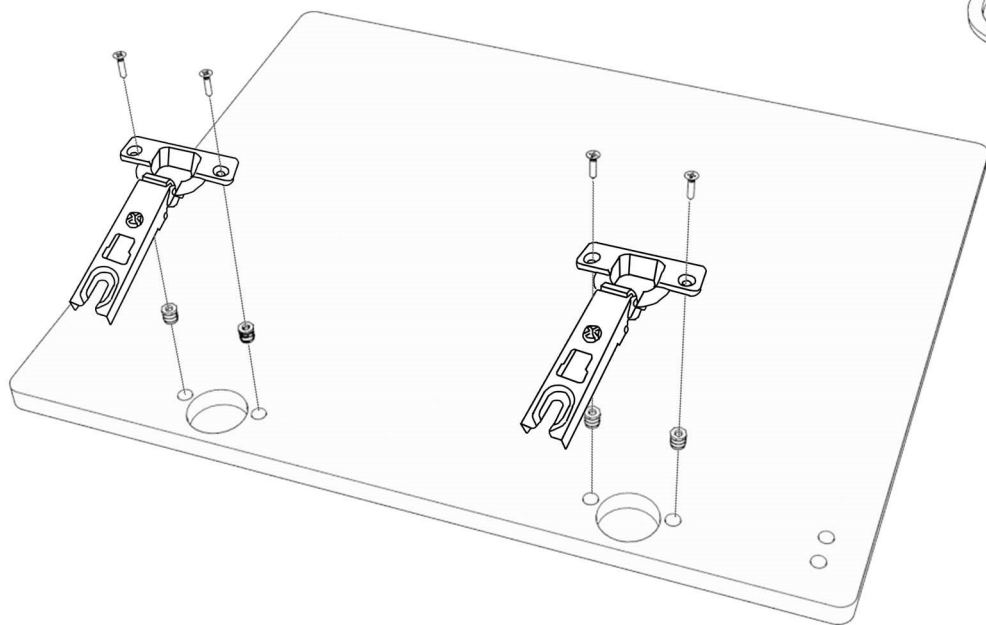

11.b

11.c



13.

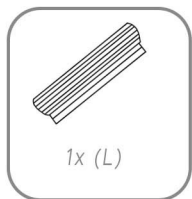

*Tambour doors should be fitted
BEFORE installing the unit
into the van.*

13.a

